

Assembly guide

EP2 Unit



WELCOME ABOARD!

Let's assemble Your dream furniture and get you on the road.

LET'S GO !

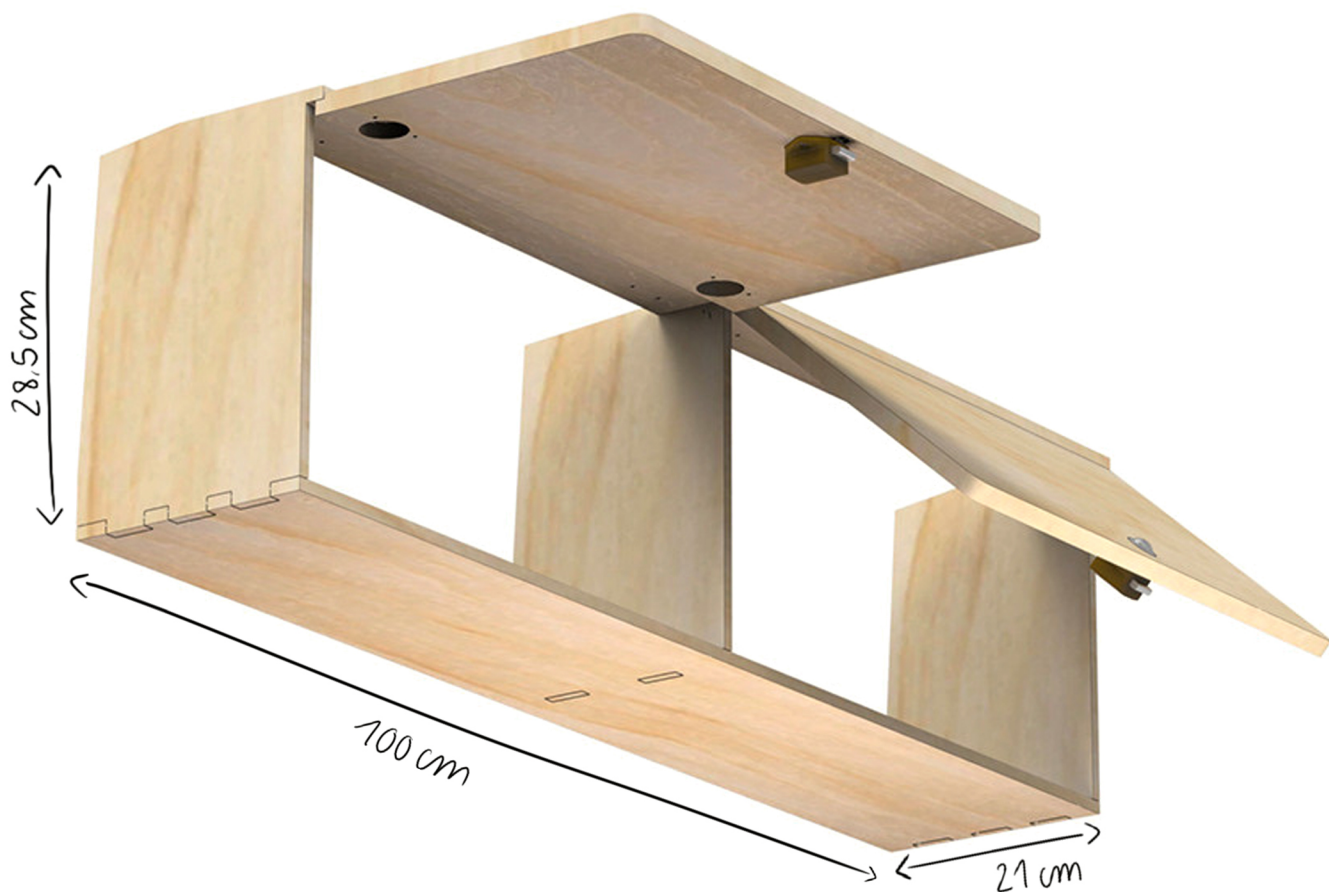

SHOW OFF YOUR SKILLS & INSPIRE THE VANLIFE COMMUNITY!

Share your build on Facebook, Instagram ou TikTok.

Use #SimpleVansLife :

Best content wins awesome prizes.



Materials required for assembly

- Masking tape
- Square (optional)
- PZ1 & PZ2 screwdriver
- Wood glue (slow-drying recommended)
- Damp cloth (or paper towel)

Package contents :

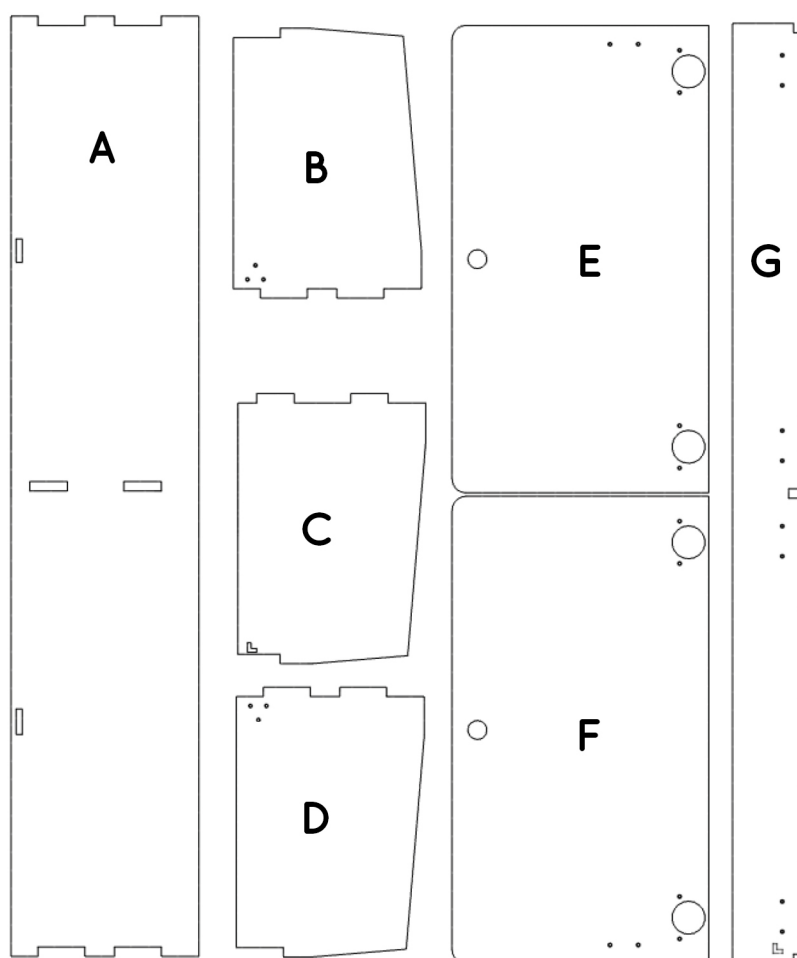
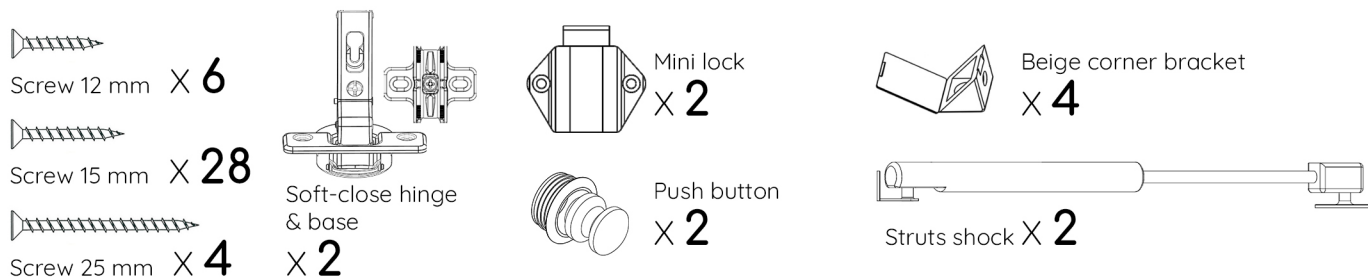

Read before assembling the furniture

- Check for chips in the grooves
- Check that the parts are free of defects before gluing / or make a dry fitting
- Read the entire instructions carefully before final assembly with glue
- Wipe off excess glue with a damp cloth immediately after gluing each piece
- Make any cuts (if necessary) before gluing the furniture
- Protect the surrounding areas of the gluing areas with masking tape to reduce cleaning

If you have a problem with a part or accessory, please contact us by email: sav@simplevans.eu



Apply a sufficient amount of glue to the contact surfaces and grooves.

The glue should **slightly protrude from the grooves when assembled**.

Wipe off excess glue with a damp cloth after assembly.

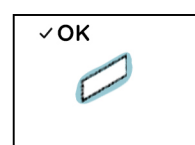
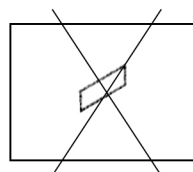
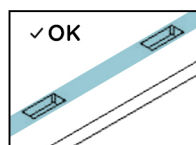
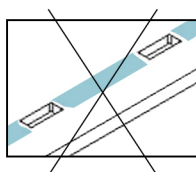

glue that comes out slightly after assembly

- 1 Apply glue to the notches and joints then assemble parts **A** and **D**.

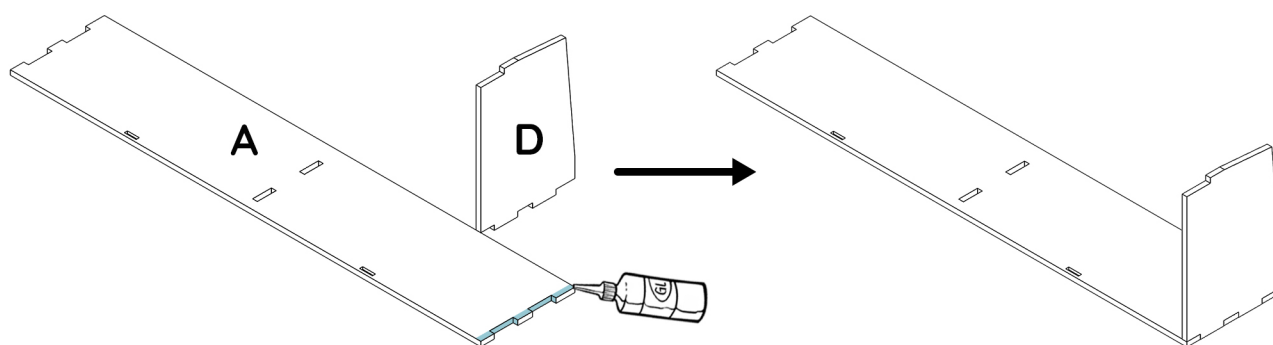

- 2 Apply glue to the notches and joints then assemble part **D** and the **A/C** assembly.

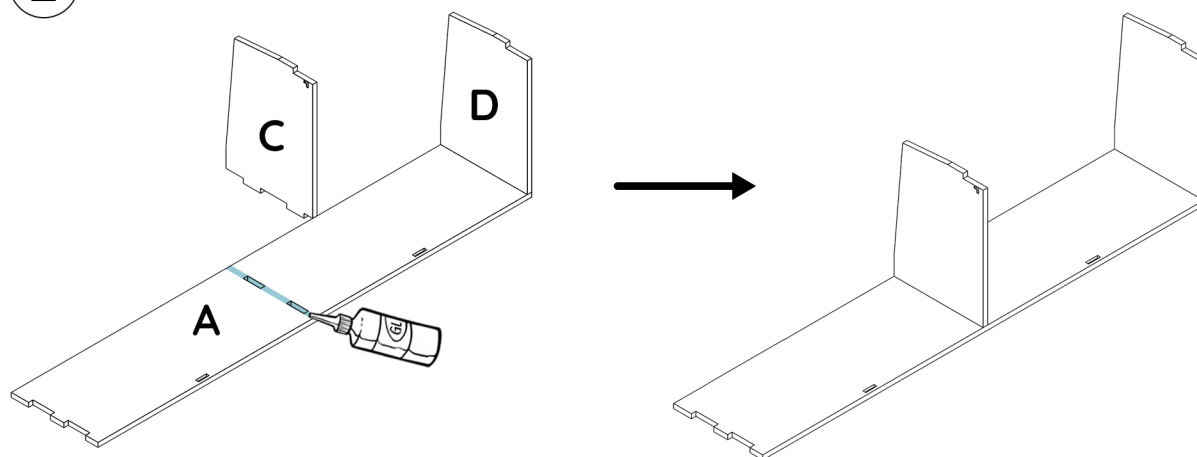

- 3 Apply glue to the notches and joints then assemble part **B** with the rest of the furniture.

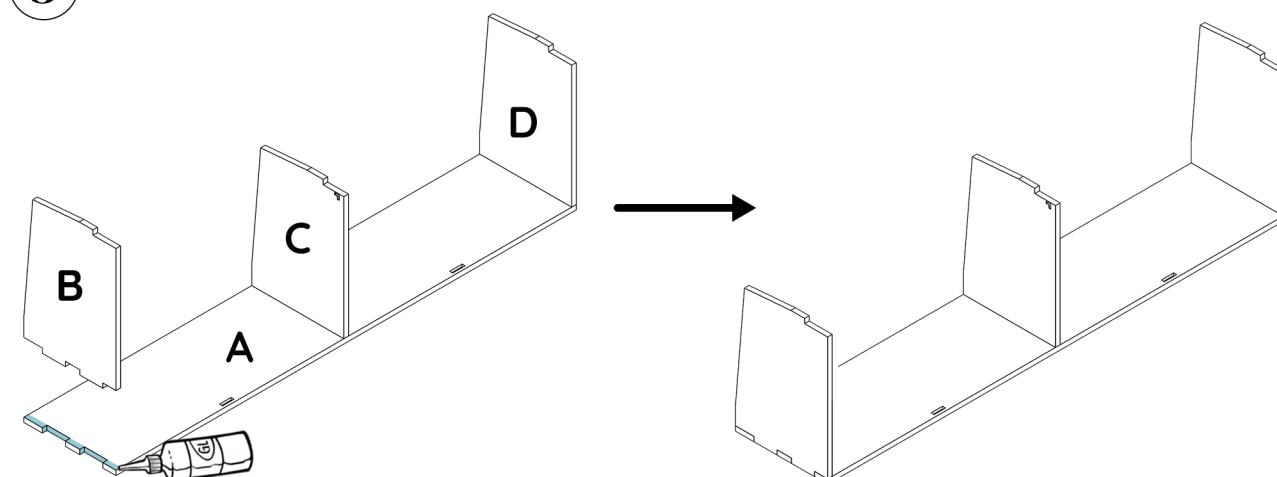

FURNITURE ASSEMBLY

- 4** Apply glue to the notches and joints and assemble part **G** with the rest of the furniture.

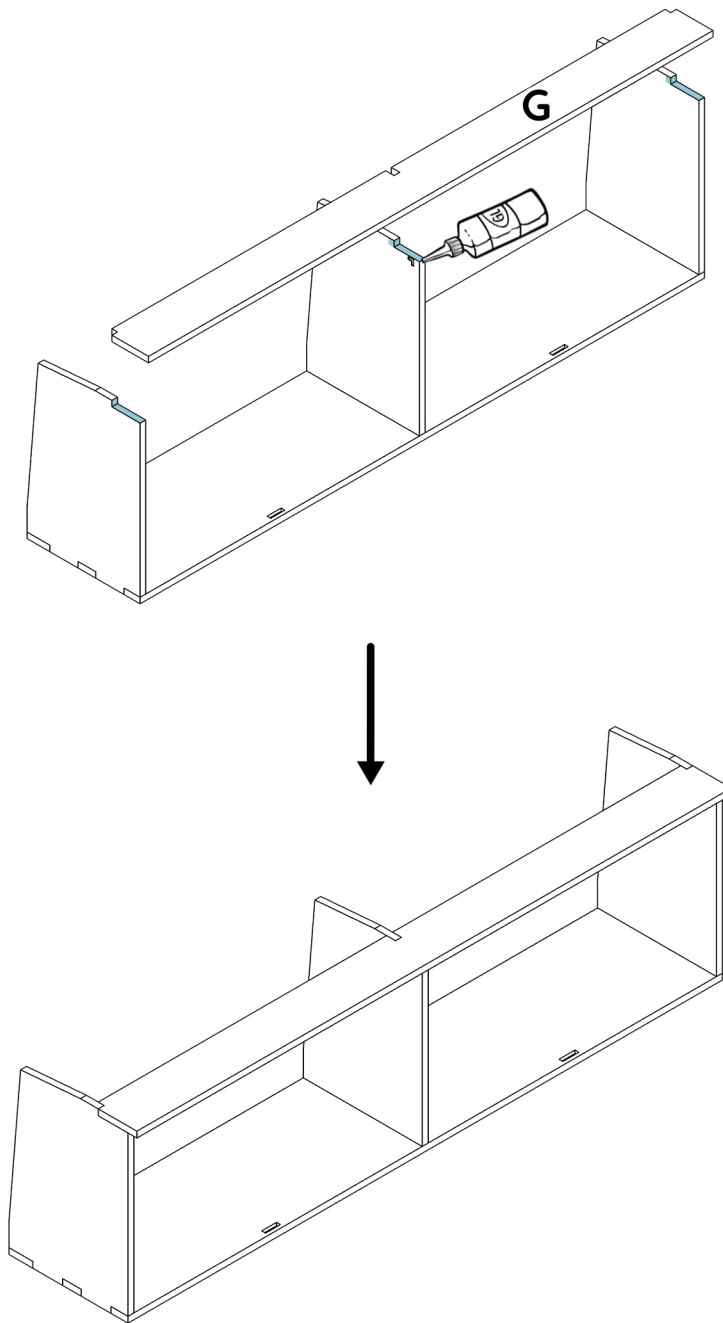



1 Mounting the push-locks on the door

- 1.1** Force-insert the push lock rosette onto the visible side of doors **E** and **F**.

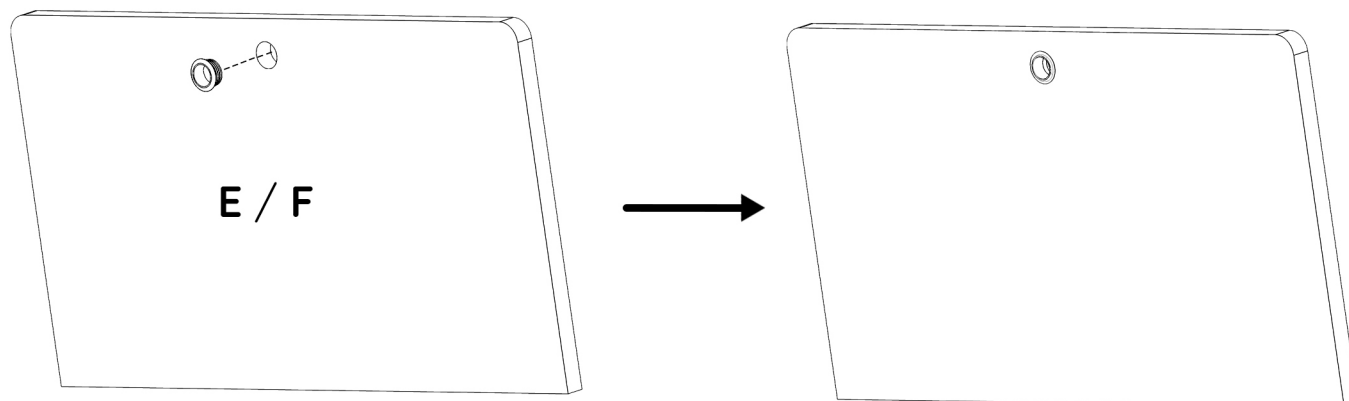

- 1.2** Screw the button onto the push lock.

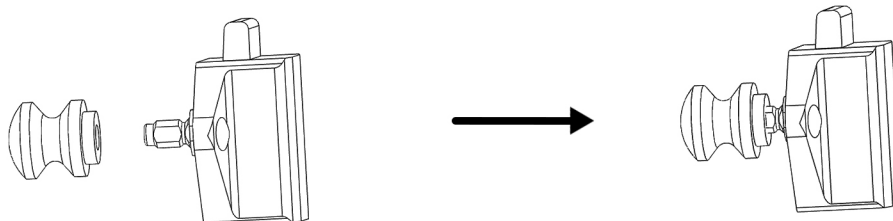

- 1.3** Screw the push lock with two 12 mm screws onto doors **E** and **F**. Make sure it is aligned with the side of the door.

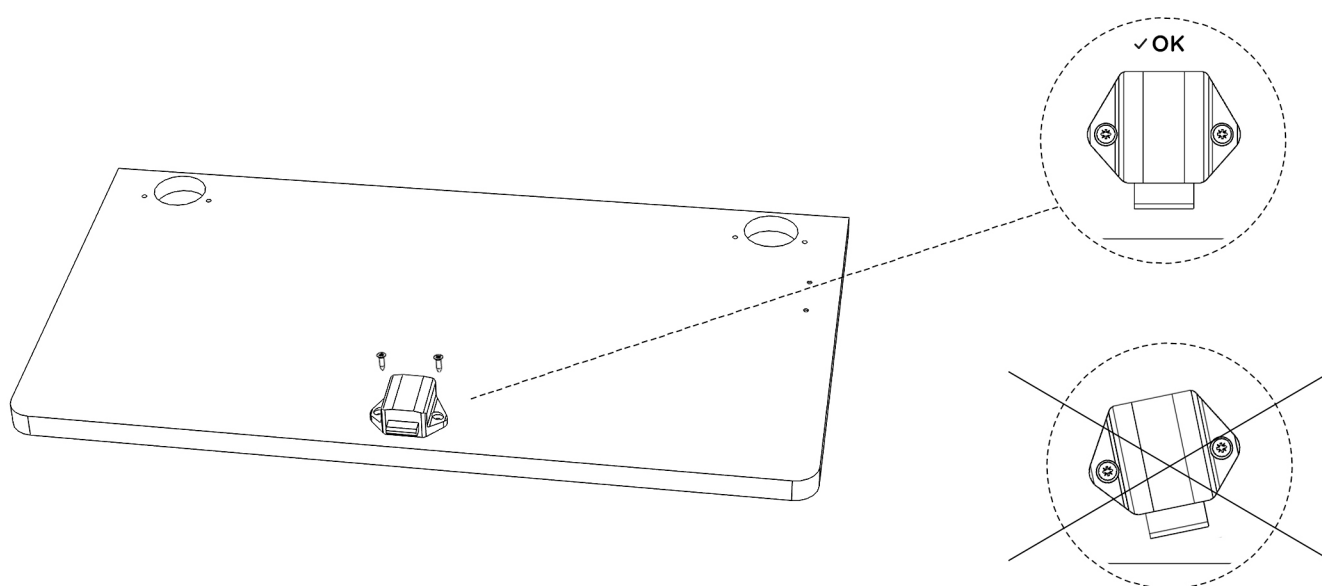

DOORS ASSEMBLY

2 Mounting the Soft Close Hinges

- 2.1** Place the soft close hinges in the slots inside door **E** and **F**, then screw them into the pilot holes provided for this purpose with 15 mm screws.

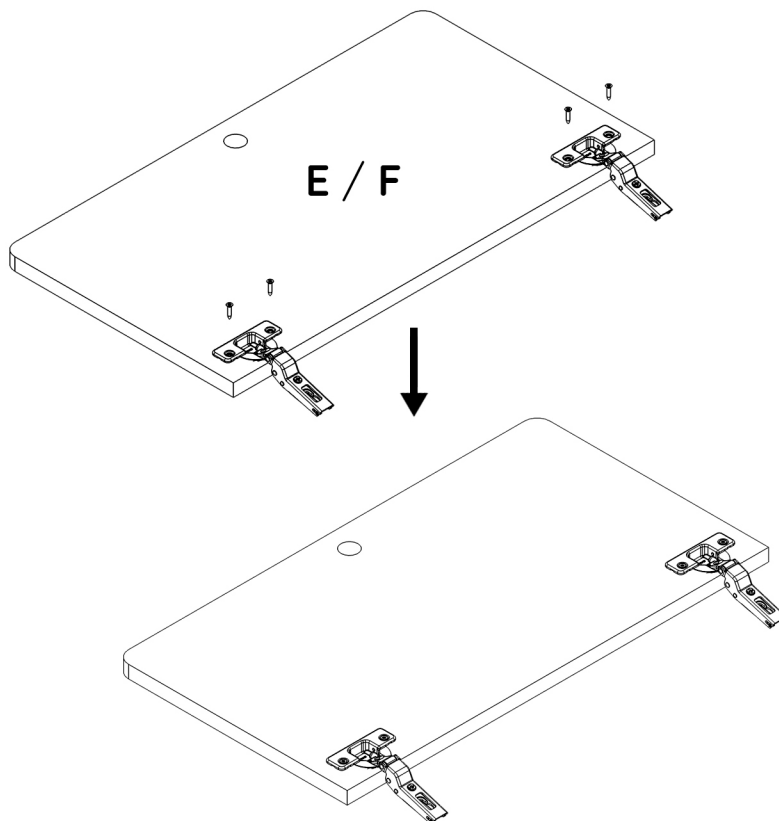

- 2.2** Fix the hinge bases to the cabinet by screwing the 15mm screws into the pilot holes as shown below.

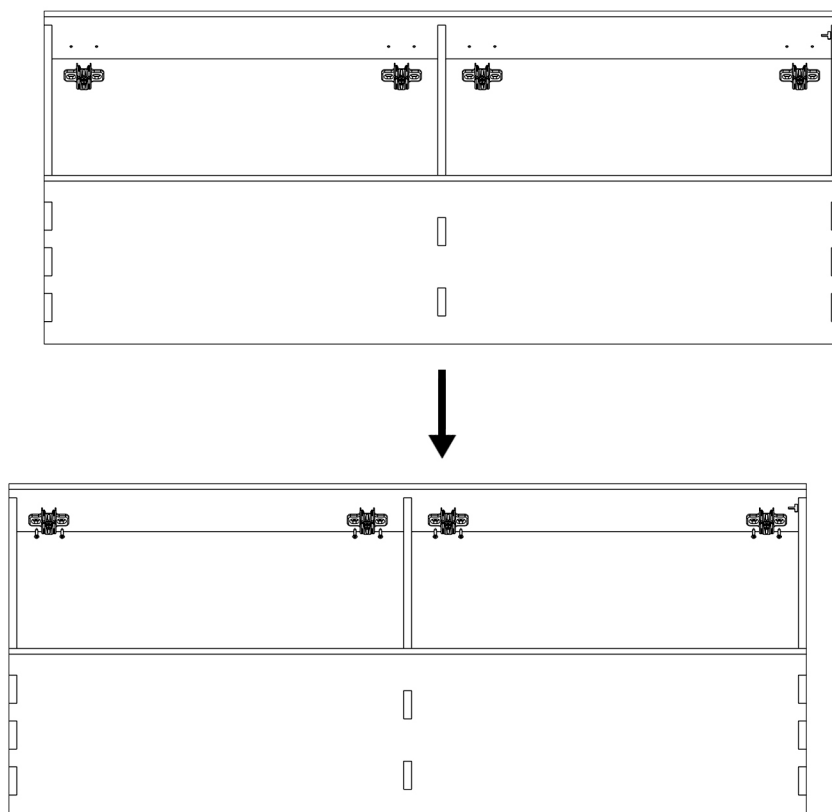

DOORS ASSEMBLY

2.3 Assemble the door hinges onto the bases fixed to the furniture as shown below.

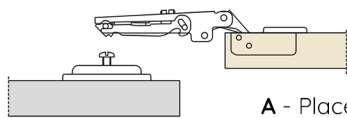

A - Place the hinge on the base.
Position with a predetermined end stop.

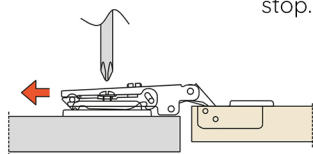

B - Tighten the fixing screw.

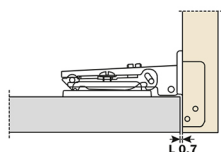

C - After installation, there is a 0.7 mm gap between the door and the side.

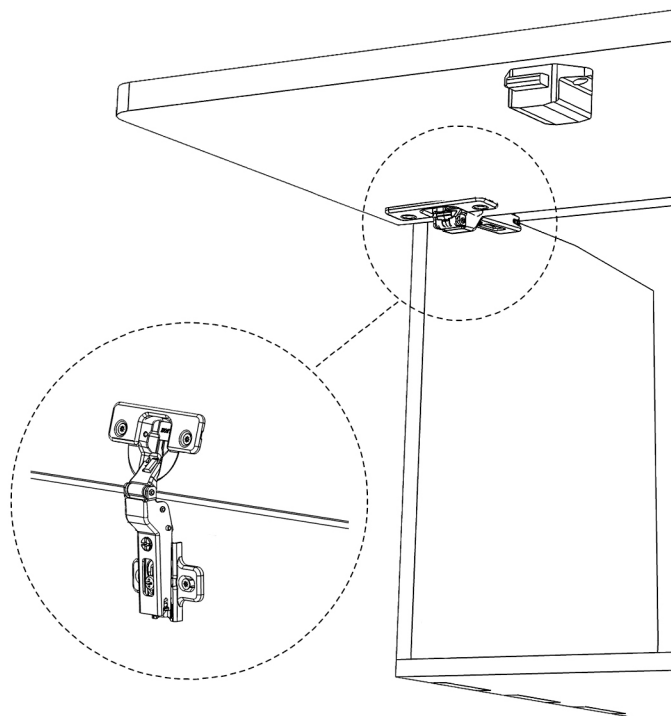

3 Strut Shocks assembly

3.1 Fix the strut bases to the **doors** (parts **E/F**), and to the **cabinet** (parts **B/D**) by screwing the 15mm screws into the pilot holes as below.

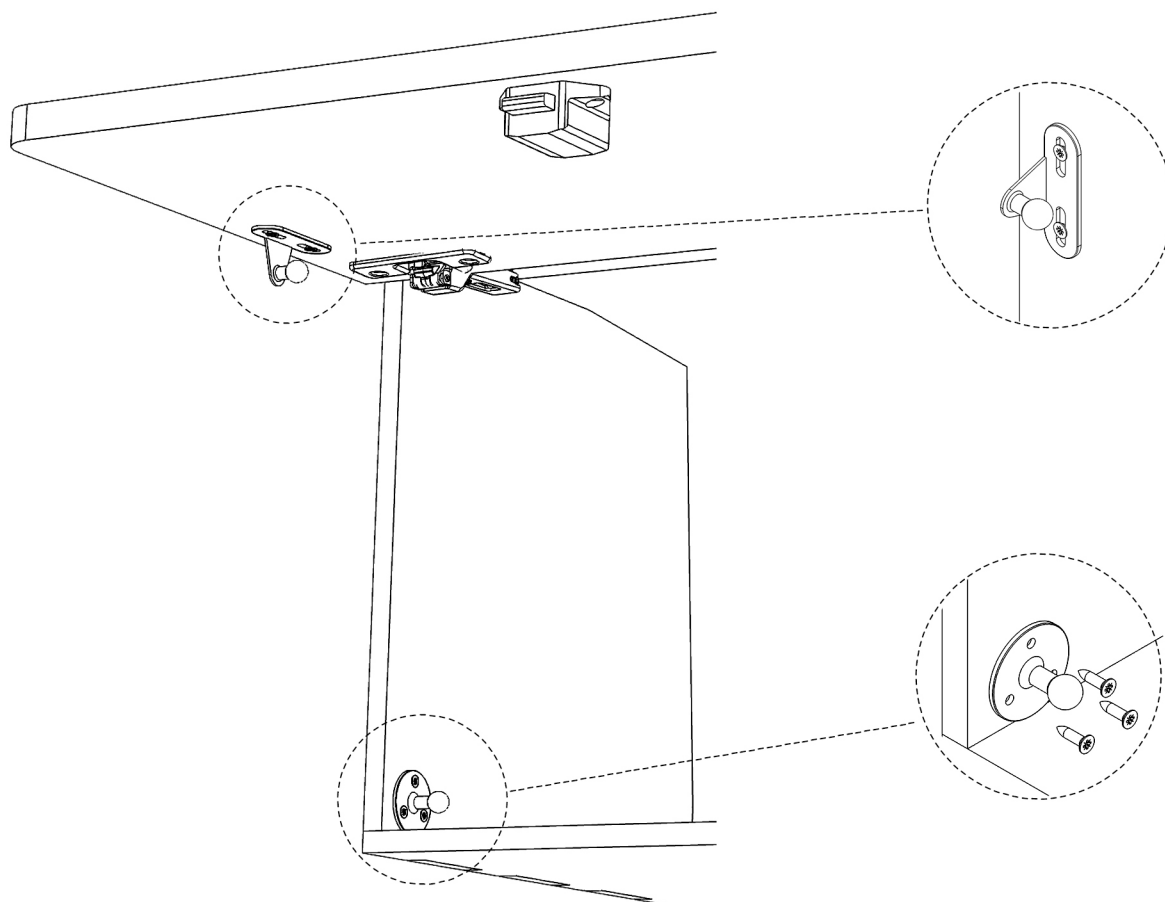

DOORS ASSEMBLY

- 3.2** Insert the bases into the struts on each side of the furniture.

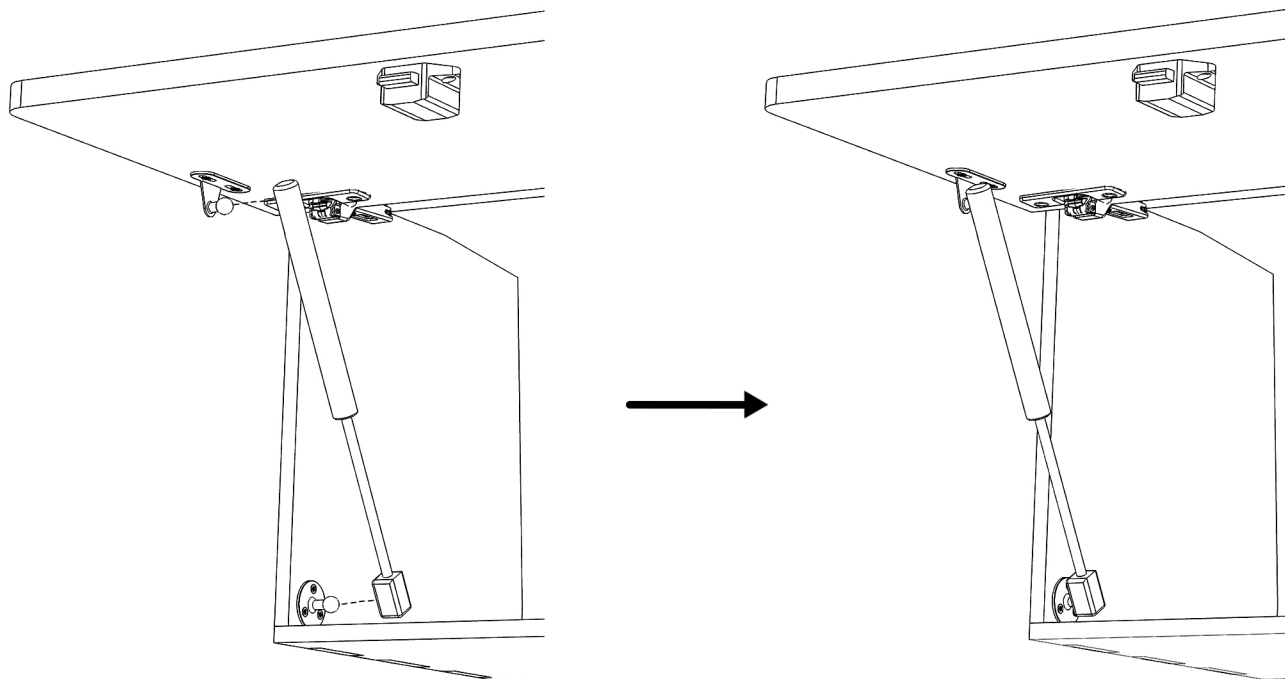

HAPPY ASSEMBLY!

If you have any comments regarding the assembly,
you can let us know by email:
sav@simplevans.eu

**ALL
TUTORIALS
HERE**



SHARE YOUR EPIC VAN BUILD JOURNEY WITH US AND THE COMMUNITY!

#SimpleVansLife

**Snap some pics or record a video of your awesome furniture
installed and ready for adventure.**

We'll feature the best content on our social media channels,
and the most inspiring builds will win incredible prizes!

