

# Assembly guide

## D9 Drawer



**WELCOME ABOARD!**

Let's assemble Your dream furniture and get you on the road.

**LET'S GO !**



## SHOW OFF YOUR SKILLS & INSPIRE THE VANLIFE COMMUNITY!

Share your build on Facebook, Instagram ou TikTok.

Use #SimpleVansLife :

**Best content wins awesome prizes.**



# Materials required for assembly

- Masking tape
- Square (optional)
- PZ1 & PZ2 screwdriver
- Wood glue (slow-drying recommended)
- Damp cloth (or paper towel)

## Package contents :



Screw 15 mm X **12**



Screw 25 mm X **6**



Screw 25 mm small diameter X **20**



Screw 45 mm X **4**

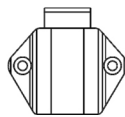

Mini lock  
X **1**



Push button  
X **1**



Drawer slide  
X **2**

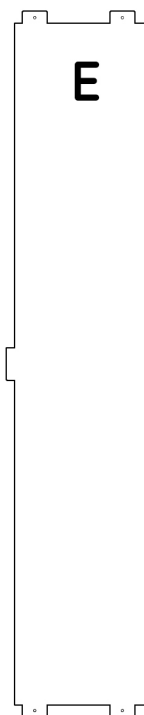
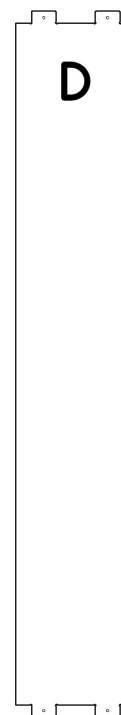
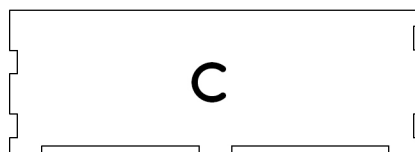
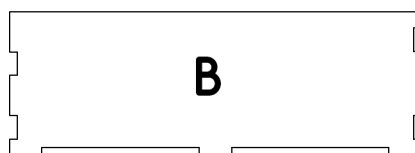
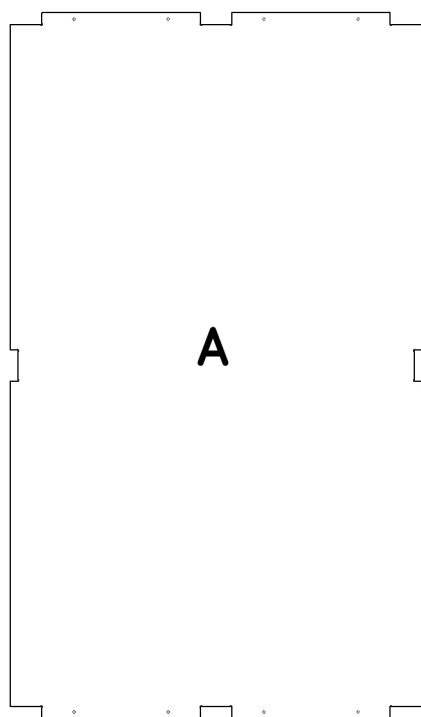

## Read before assembling the furniture

- Check for chips in the grooves
- Check that the parts are free of defects before gluing / or make a dry fitting
- Read the entire instructions carefully before final assembly with glue
- Wipe off excess glue with a damp cloth immediately after gluing each piece
- Make any cuts (if necessary) before gluing the furniture
- Protect the surrounding areas of the gluing areas with masking tape to reduce cleaning

If you have a problem with a part or accessory, please contact us by email: [sav@simplevans.eu](mailto:sav@simplevans.eu)

# DRAWER ASSEMBLY



Estimated time: 30 min



Apply a sufficient amount of glue to the contact surfaces and grooves.

The glue should **slightly protrude from the grooves when assembled**.

**Wipe off excess glue** with a damp cloth after assembly.

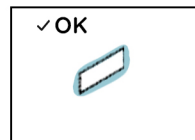
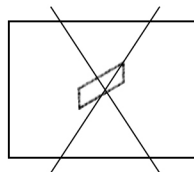
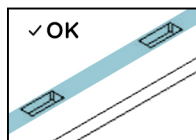
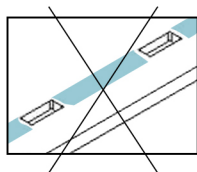

glue that slightly protrudes  
after assembly

1

Pre-drill and partially insert the 8 small-diameter 25mm screws into the pre-drilled holes of part **A**.

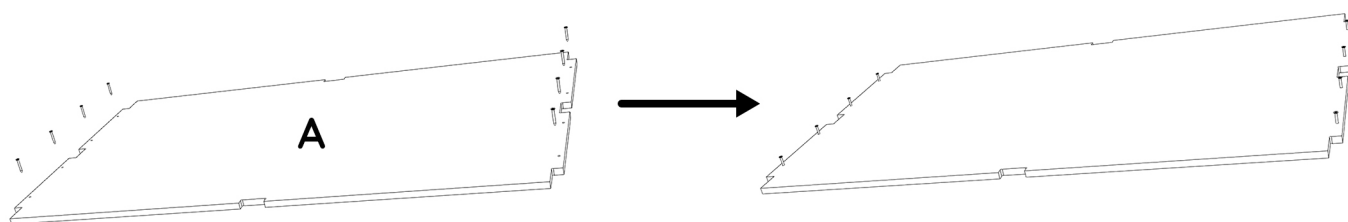

2

Apply glue, then assemble and screw parts **B** and **C** to part **A**.  
Ensure that all parts are oriented in the same direction.

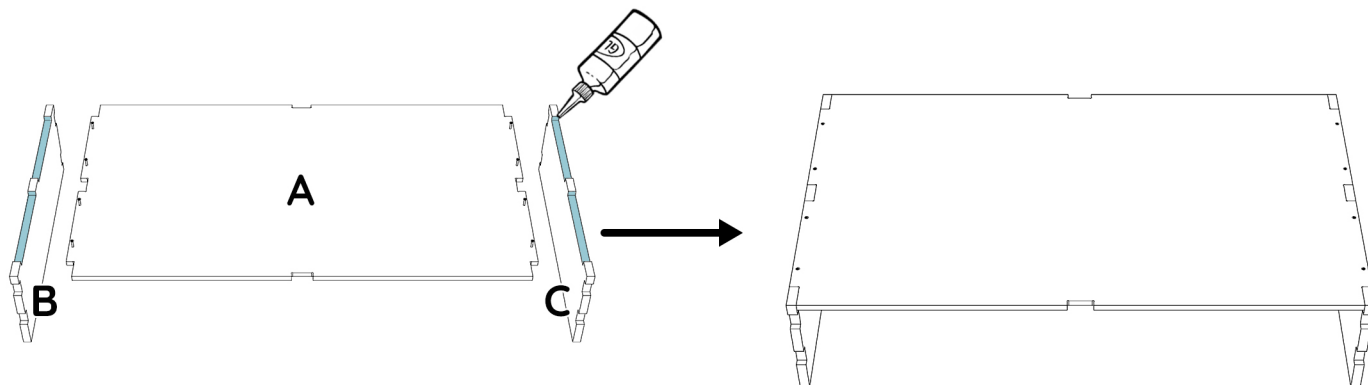

3

Pre-drill and partially insert the 8 small-diameter 25mm screws into the pre-drilled holes of parts **D** and **E**.

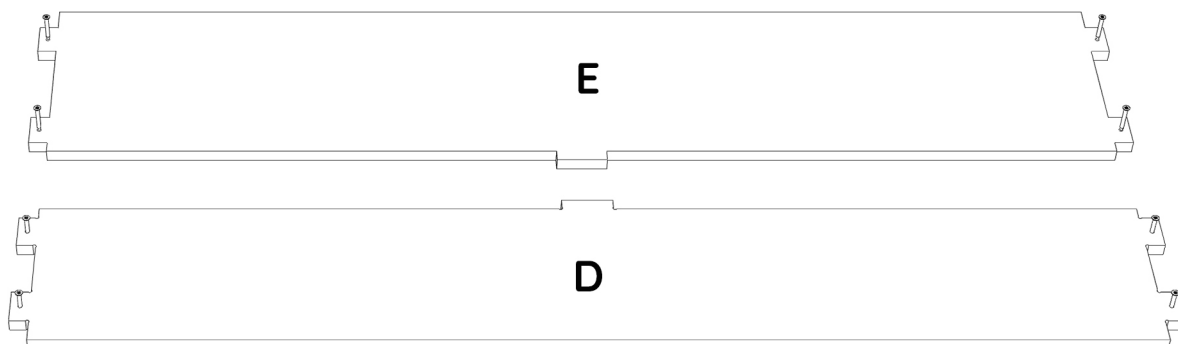



## DRAWER ASSEMBLY

- 4** Apply glue to the joining surfaces of parts **D** and **E**, then attach them to the rest of the drawer using screws.

**i** Part **D** (17cm high) will be the **back of the drawer** and part **E** (14cm high) will be the **front of the drawer** (where the front panel is attached).

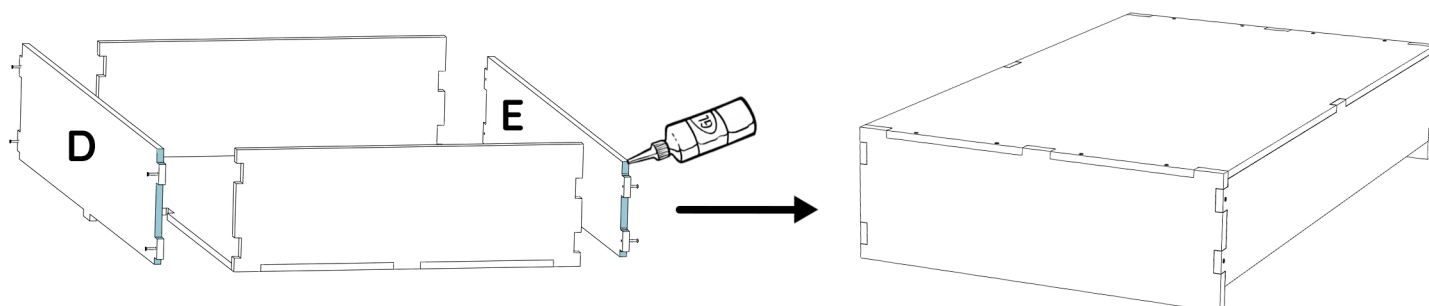

## **5** Installing the drawer slides

- 5.1** Disassemble the drawer slides into two halves by fully extending them and releasing the black locking mechanism.

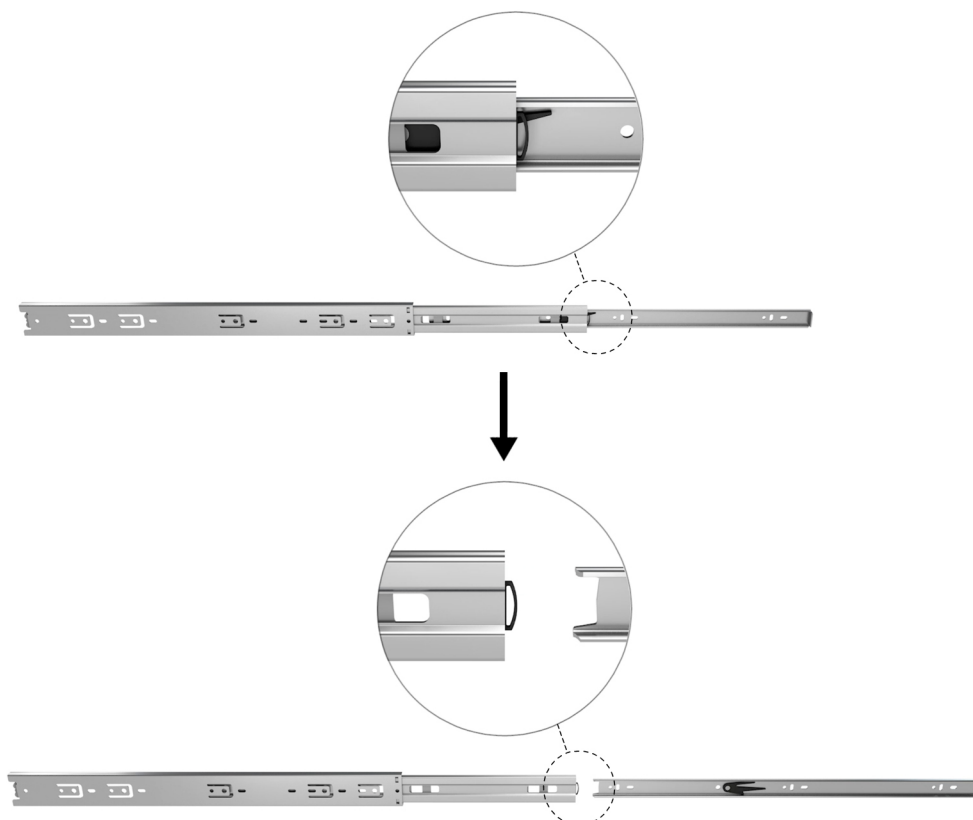

## DRAWER ASSEMBLY

- 5.2** Position the slides 15mm back from the front panel as shown below. Align the bottom of the slides with the top edge of the drawer bottom, then screw each one in place with 3 x 15mm screws.

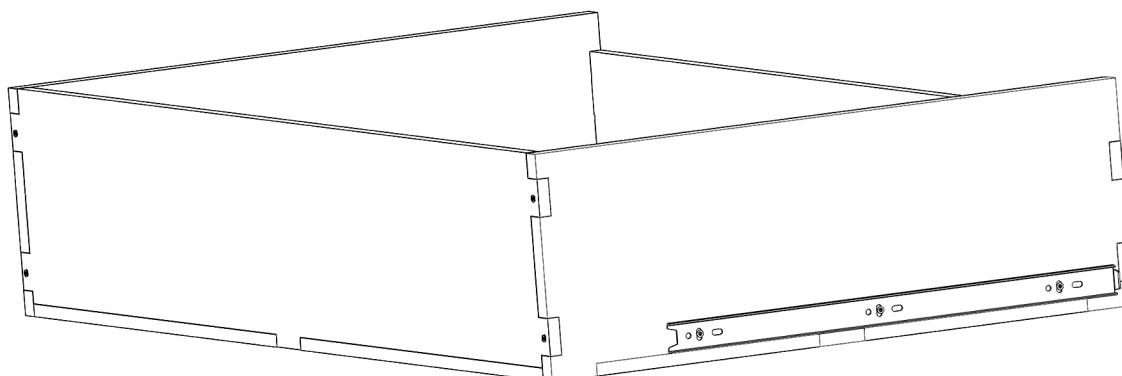
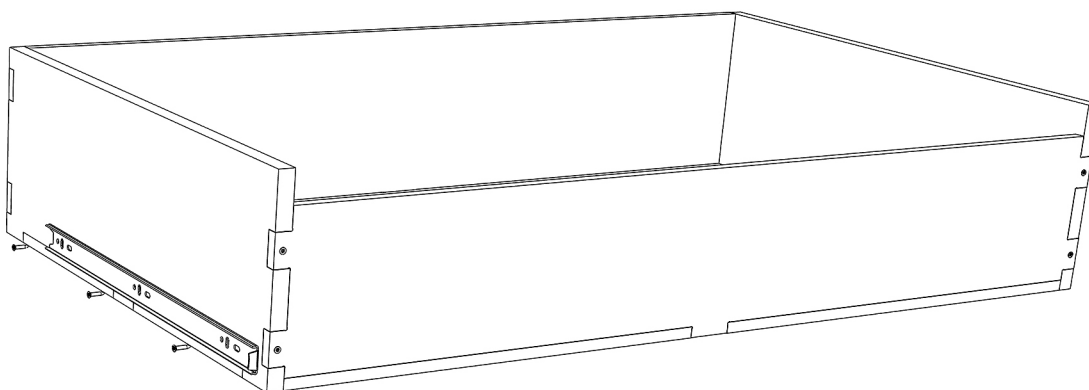
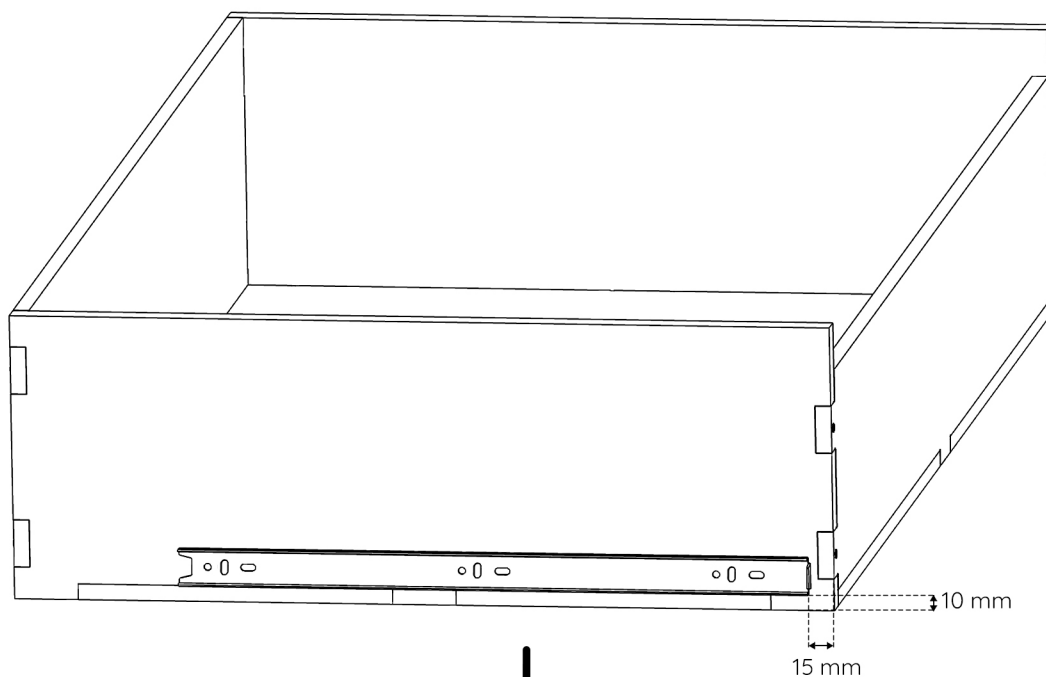



1

## Installing the slide supports on the bed

Apply glue and align, then screw the slide supports **F** and **G** to the bed using 45mm screws as shown below. Ensure that the pre-drilled holes are facing towards the center of the bed.

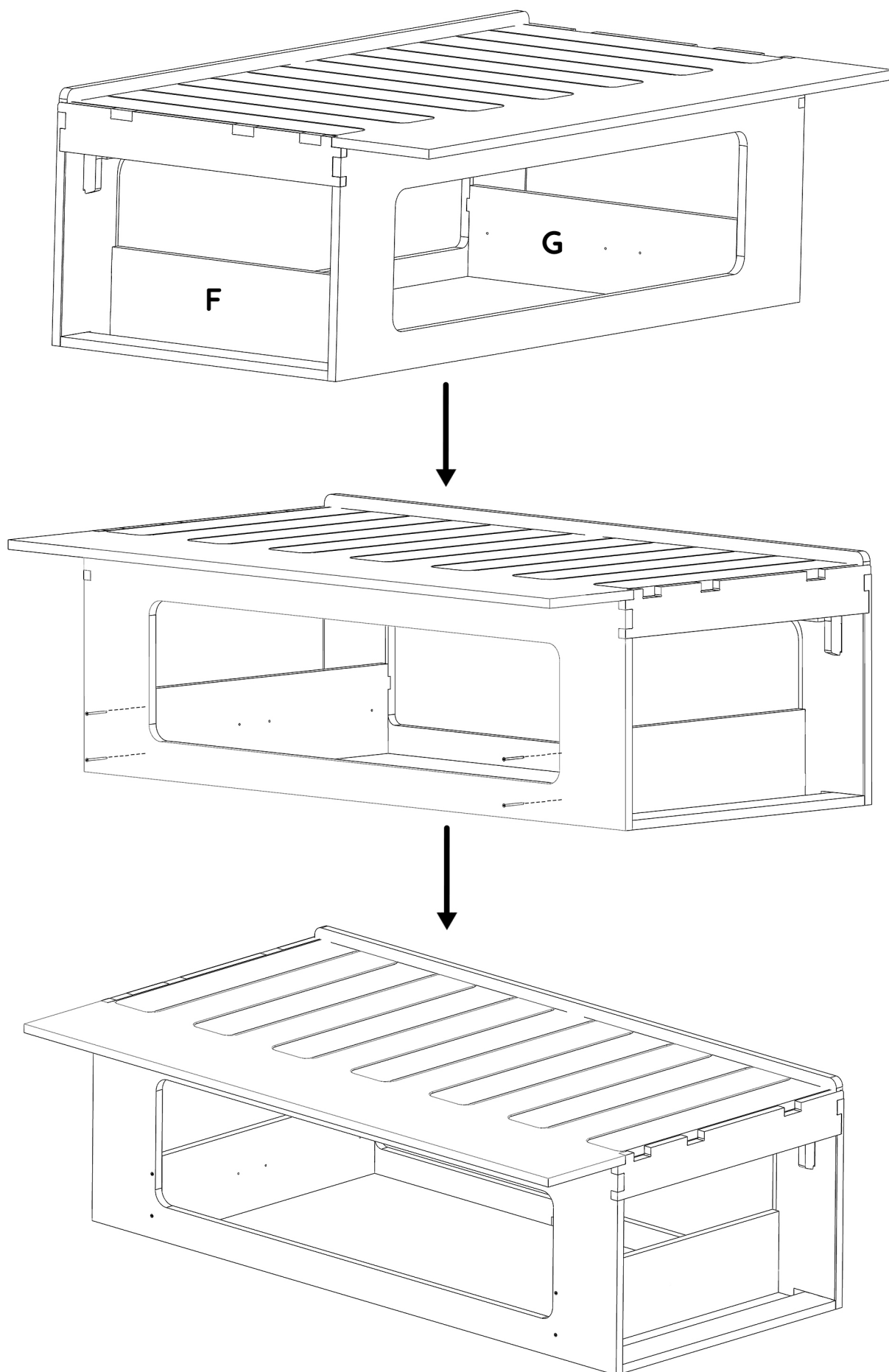

## SLIDE SUPPORTS, PUSH LOCK & FRONT FRAME

- 2** Attach the 400mm slides to the inside of the bed with 3 x 15mm screws in the pre-drilled holes of the supports.

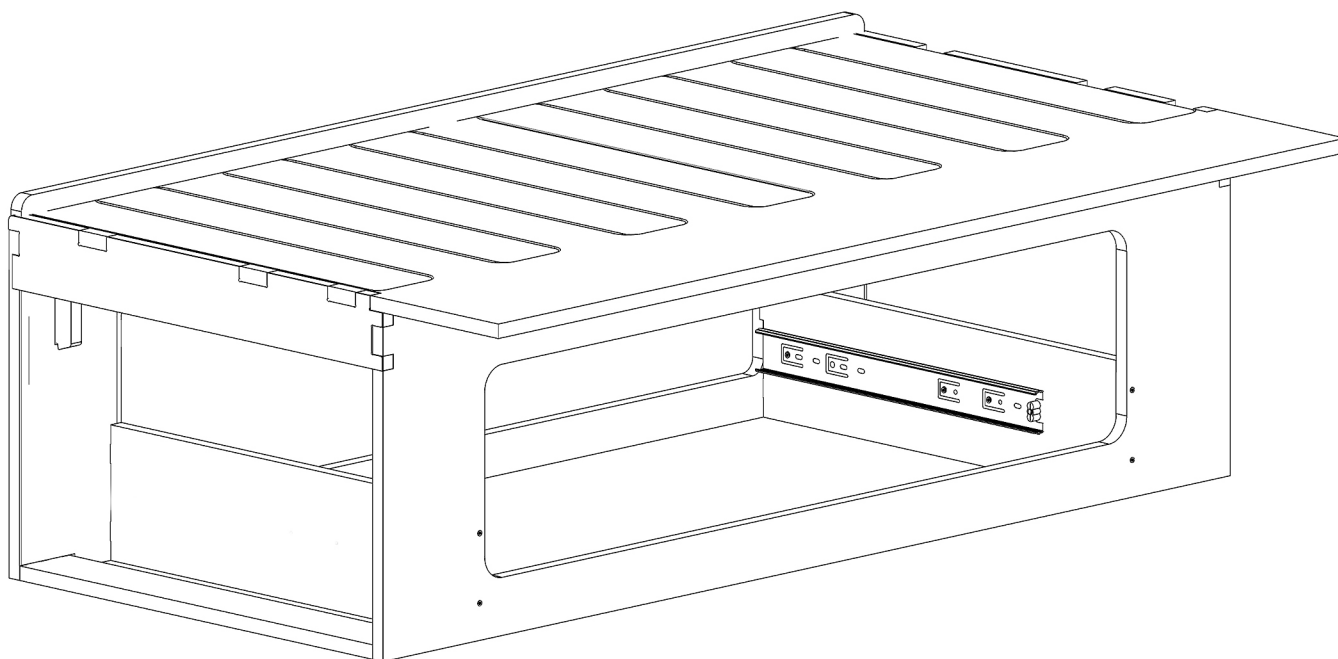
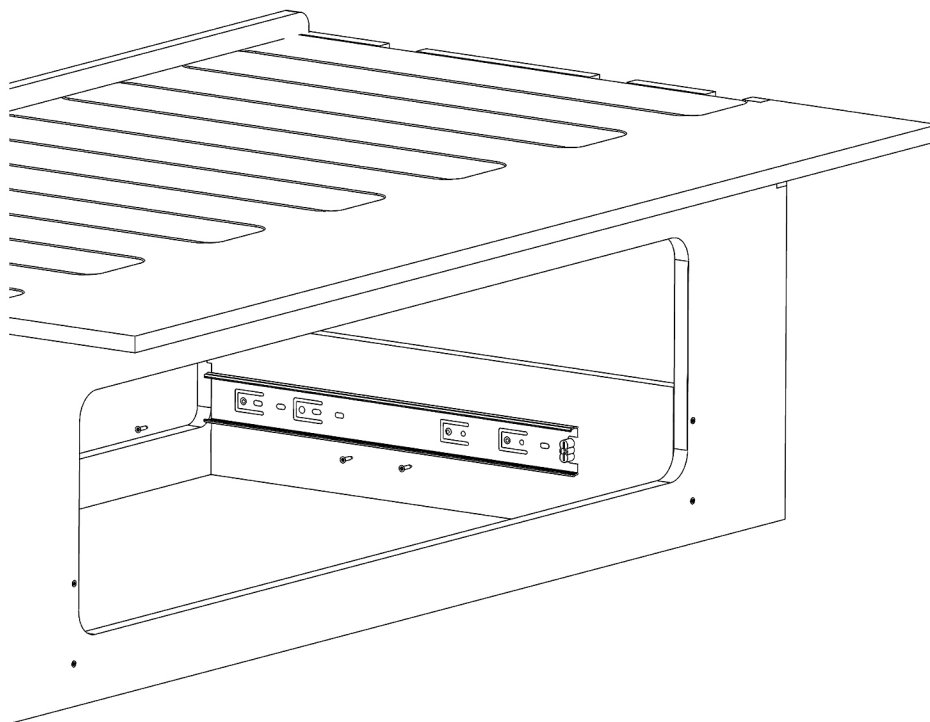



## SLIDE SUPPORTS, PUSH LOCK & FRONT FRAME

### 3 Installing the front panel

3.1 Pre-drill two 25mm diameter screws into piece **E**.

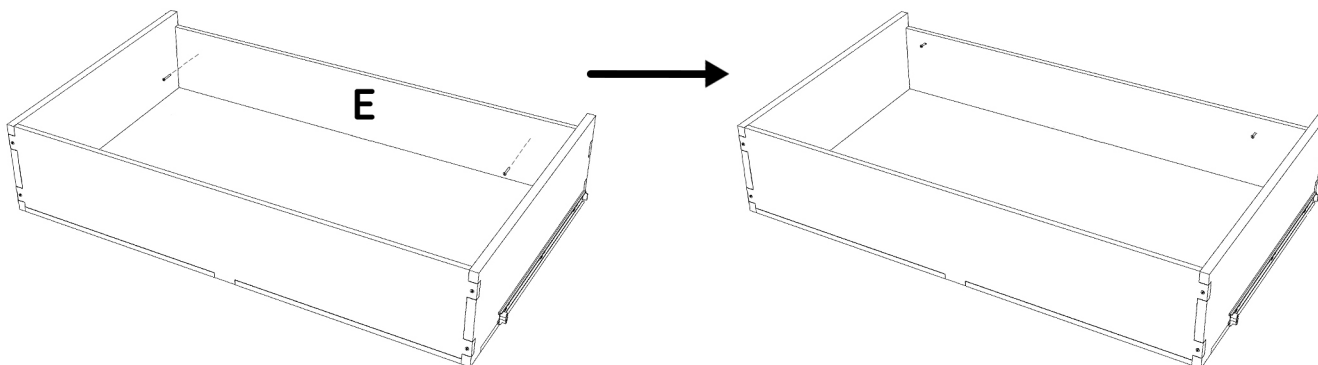

3.2 Insert the drawer into the bed slides.

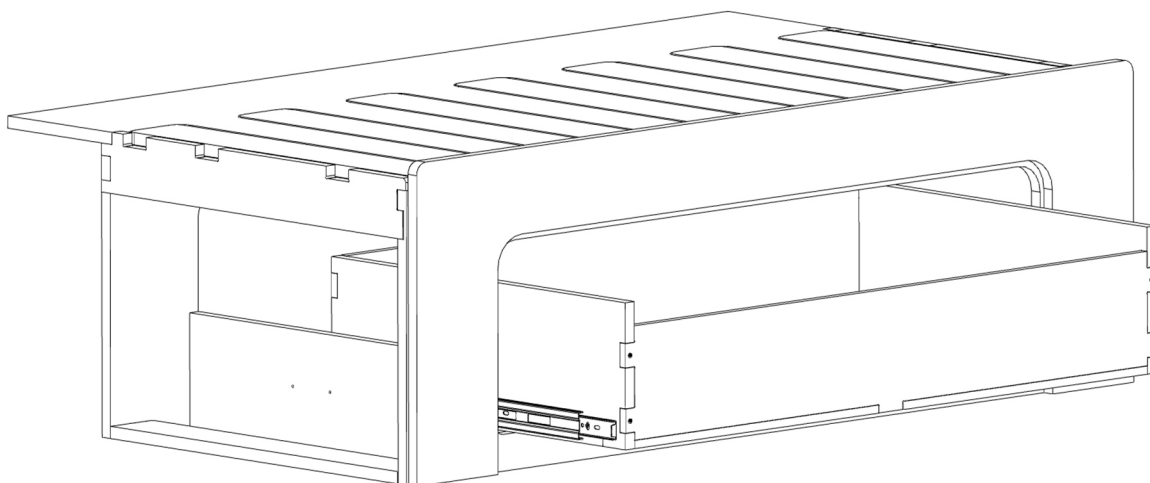

3.3 Place and center the bed front panel in its frame. To facilitate access to the drawer interior, remove the movable part of the bed while holding the front panel in place, and **secure the front panel's position by tightening the two pre-installed screws** on piece **E**.

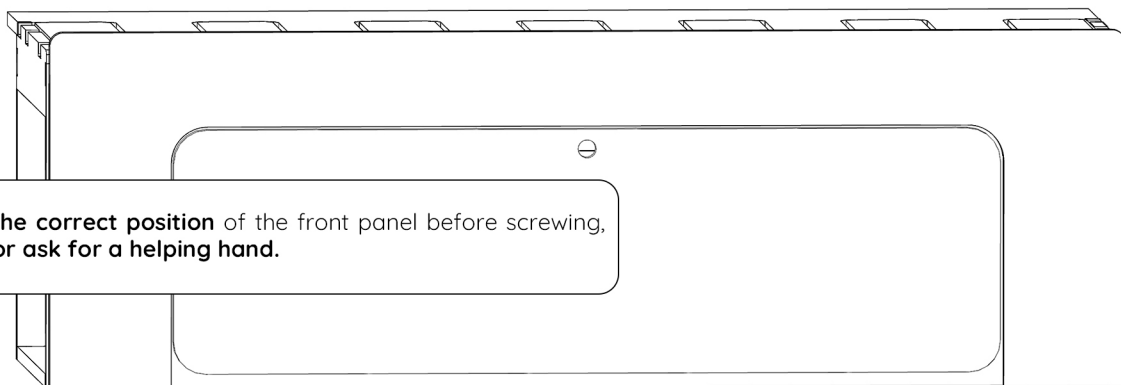

**i** To maintain the correct position of the front panel before screwing, use spacers, or ask for a helping hand.

# SLIDE SUPPORTS, PUSH LOCK & FRONT FRAME

- 3.4 Complete the installation of the front panel by **securing it with 4 additional 25mm diameter screws** from the inside of the drawer.

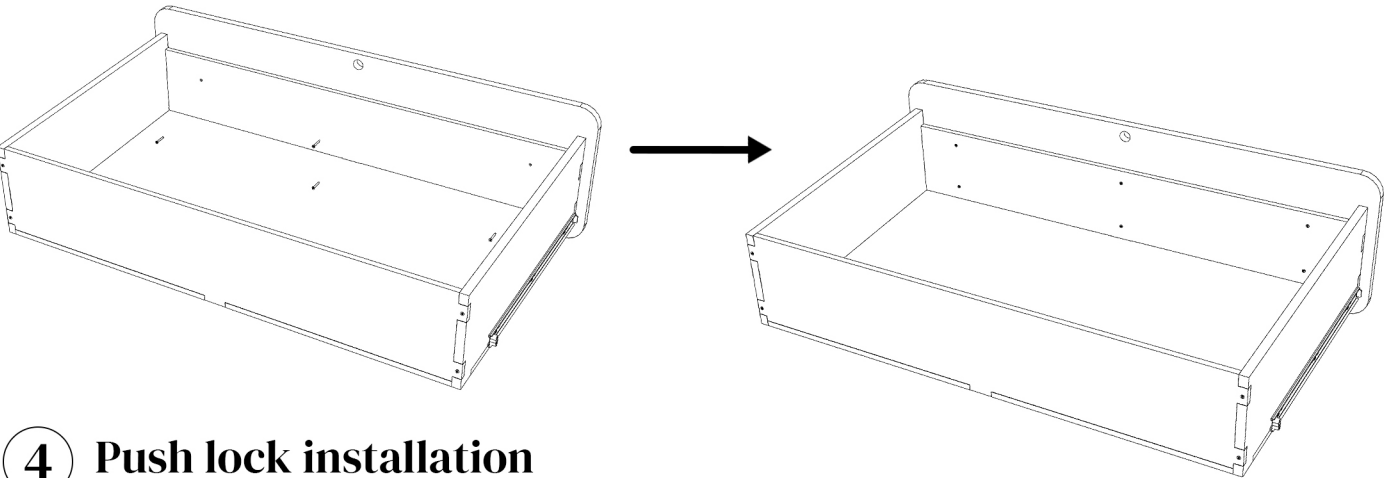

## 4 Push lock installation

- 4.1 Forcefully insert the push lock rosette onto the front of the drawer.

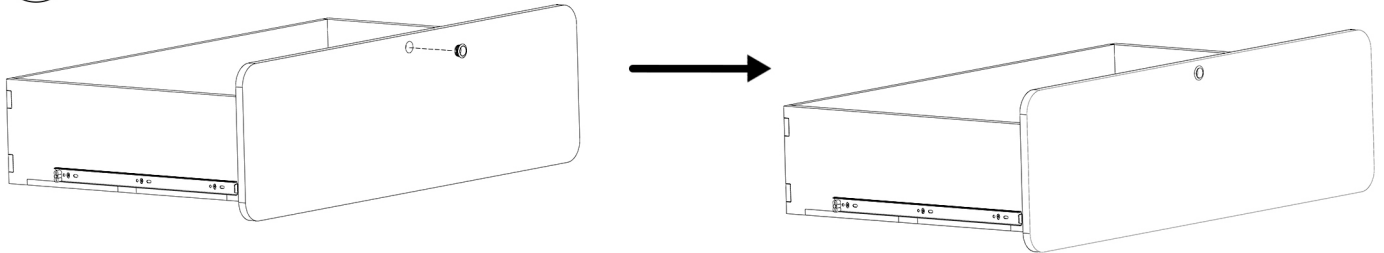

- 4.2 Screw the **button** onto the push lock.

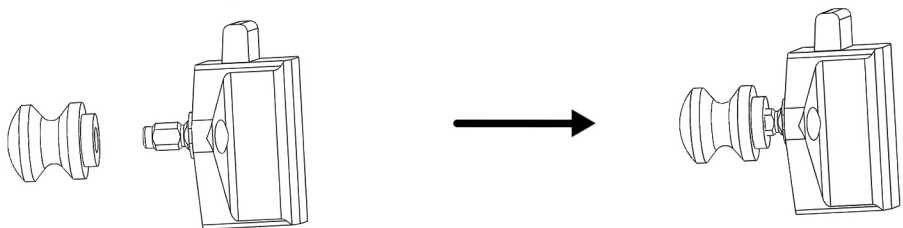

- 4.3 Secure the push lock in place with 2 x 12mm screws from the inside of piece **C**. **Ensure it is aligned with the bottom edge of the piece.**

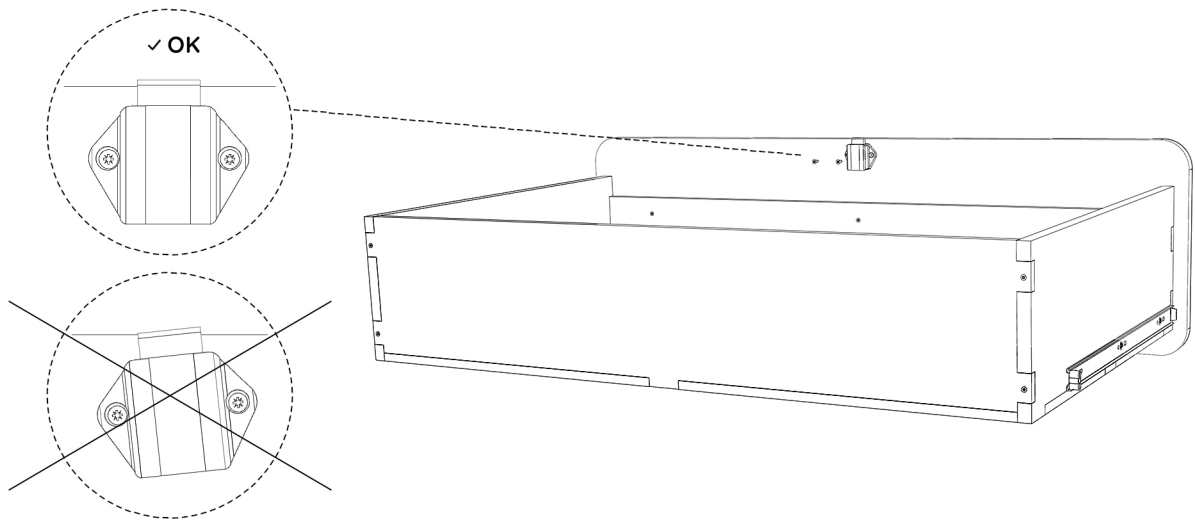

## SLIDE SUPPORTS, PUSH LOCK & FRONT FRAME

### 5 Drawer installation & adjustment

- 5.1 Slide the drawer into the slides until you hear the locking "click".

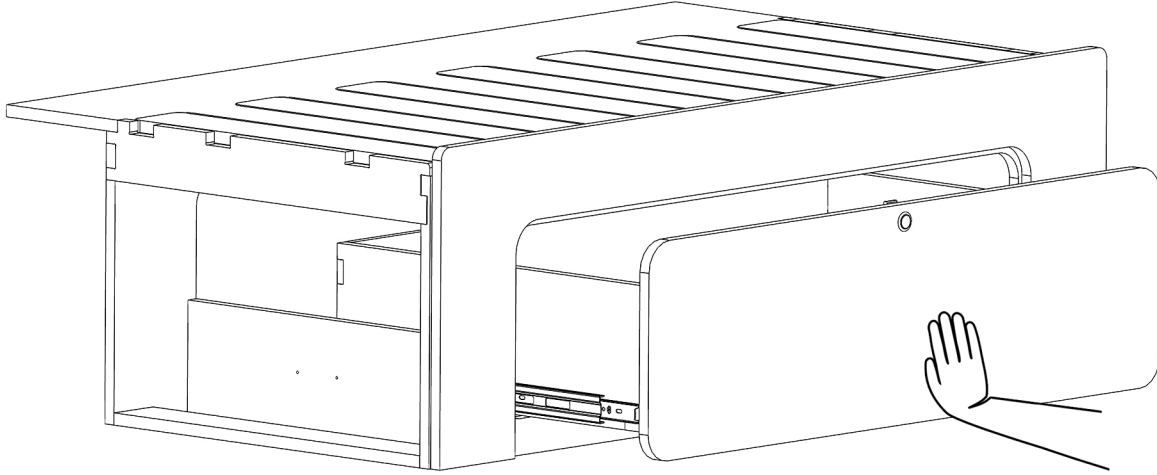

- 5.2 To **adjust the drawer height**, loosen the drawer slide mounting screws, reposition the drawer vertically, and then retighten the 15mm screws.

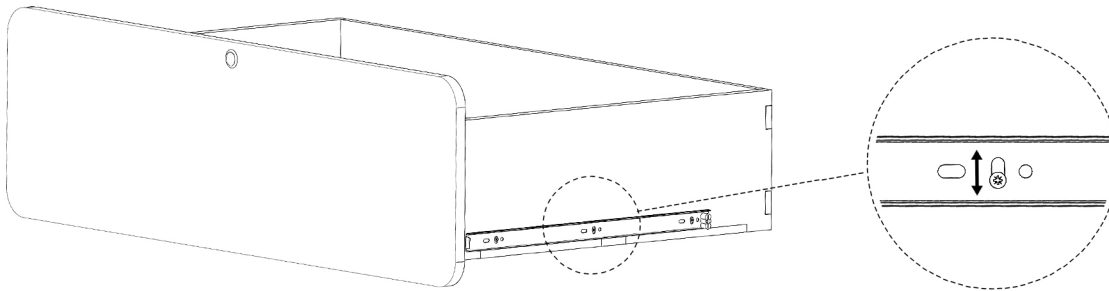

# HAPPY ASSEMBLY!

If you have any comments regarding the assembly,  
you can let us know by email:  
**sav@simplevans.eu**

**ALL  
TUTORIALS  
HERE**



## SHARE YOUR EPIC VAN BUILD JOURNEY WITH US AND THE COMMUNITY!

#SimpleVansLife

**Snap some pics or record a video of your awesome furniture  
installed and ready for adventure.**

We'll feature the best content on our social media channels,  
and the most inspiring builds will win incredible prizes!

