

Assembly guide

D7 Drawer



WELCOME ABOARD!

Let's assemble Your dream furniture and get you on the road.

LET'S GO !



SHOW OFF YOUR SKILLS & INSPIRE THE VANLIFE COMMUNITY!

Share your build on Facebook, Instagram ou TikTok.

Use #SimpleVansLife :

Best content wins awesome prizes.



Materials required for assembly

- Masking tape
- Square (optional)
- PZ1 & PZ2 screwdriver
- Wood glue (slow-drying recommended)
- Damp cloth (or paper towel)

Package contents :



Screw 15 mm X **12**



Screw 25 mm X **6**

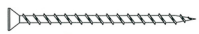

Screw 25 mm small diameter X **18**



Drawer Slide

X **2**

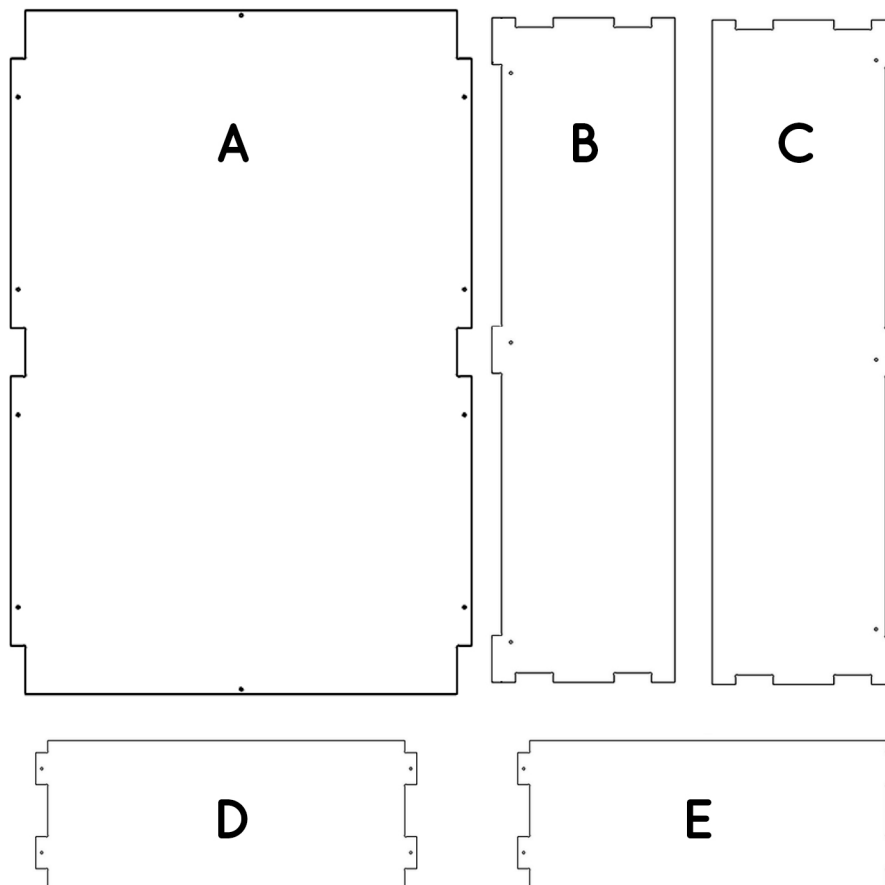

Read before assembling the furniture

- Check for chips in the grooves
- Check that the parts are free of defects before gluing / or make a dry fitting
- Read the entire instructions carefully before final assembly with glue
- Wipe off excess glue with a damp cloth immediately after gluing each piece
- Make any cuts (if necessary) before gluing the furniture
- Protect the surrounding areas of the gluing areas with masking tape to reduce cleaning

If you have a problem with a part or accessory, please contact us by email: sav@simplevans.eu

DRAWER ASSEMBLY



Estimated time: 30 min



Apply a sufficient amount of glue to the contact surfaces and grooves.

The glue should **slightly protrude from the grooves when assembled**.

Wipe off excess glue with a damp cloth after assembly.

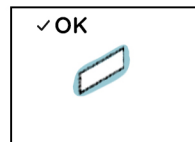
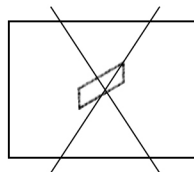
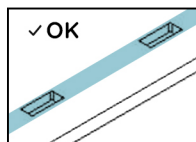
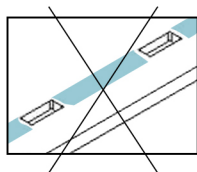

glue that slightly protrudes
after assembly

1

Pre-screw the 8 small diameter 25 mm screws into the pilot holes of part **A**.

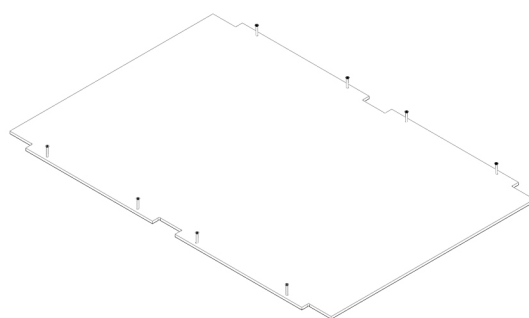
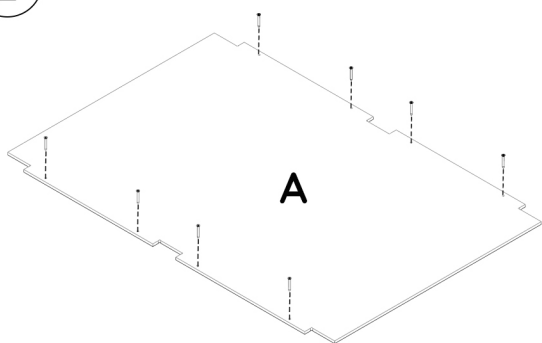

2

Apply glue, then assemble and screw parts **B** and **C** together with part **A**.
Be careful to orient the parts in the same direction!

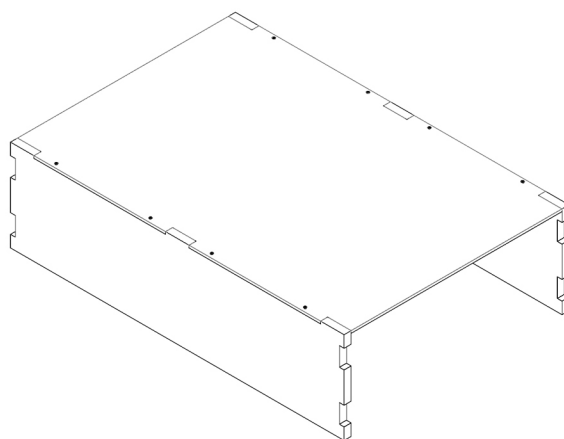
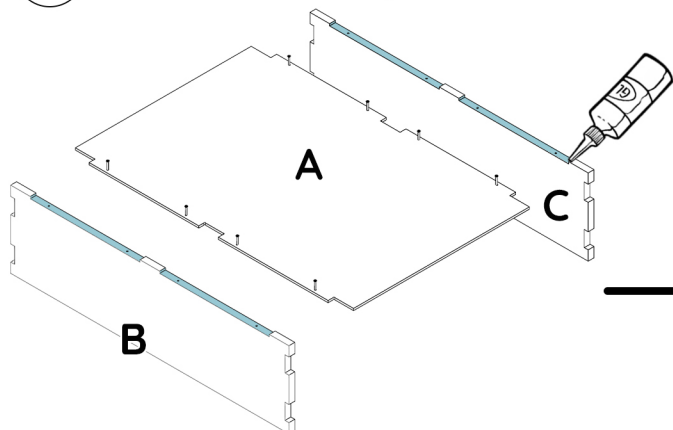

3

Pre-screw the 8 small diameter 25 mm screws into the pilot holes of parts **D** and **E**.

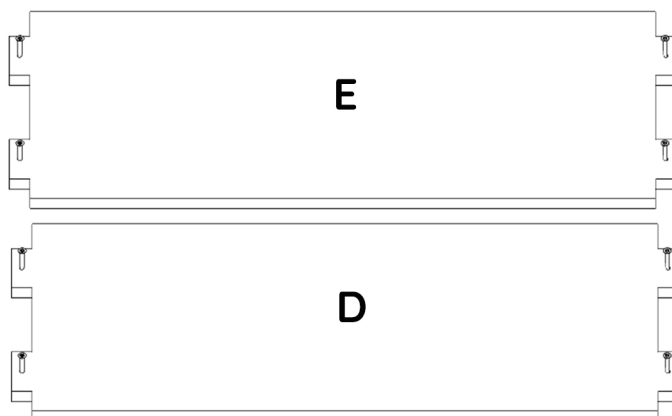

DRAWER ASSEMBLY

- 4** Apply glue and screw parts **D** and **E** to the rest of the drawer.

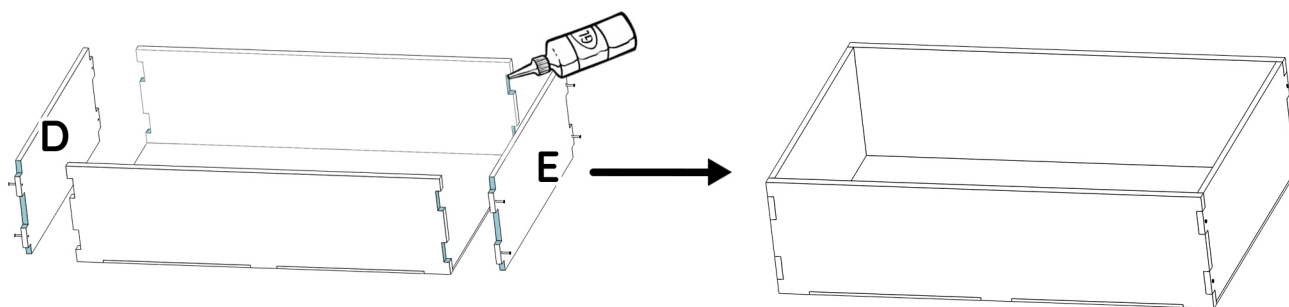

5 Mounting the slides on the drawer

- 5.1** Disassemble the slides into 2 parts by pulling them as far as possible and unlocking them using the black part.

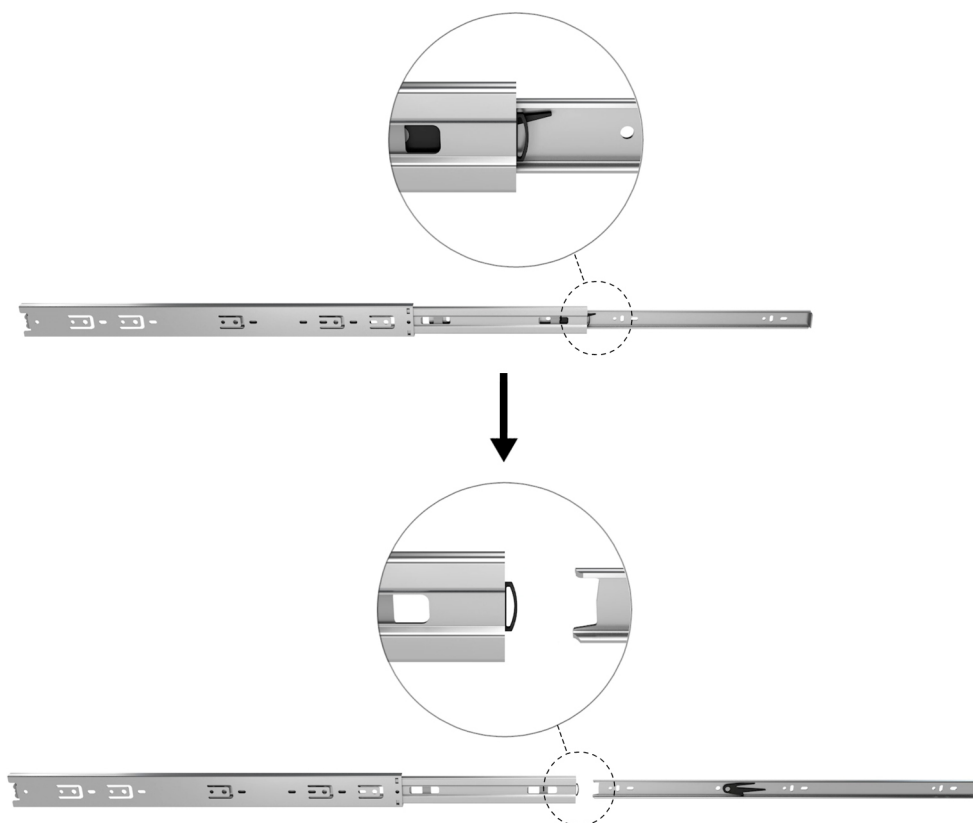

DRAWER ASSEMBLY

- 5.2** Position the 70 cm slides on the outer sides of the drawer, aligning them as shown below, then screw each one in place using 3 x 15 mm screws in the pilot holes provided.

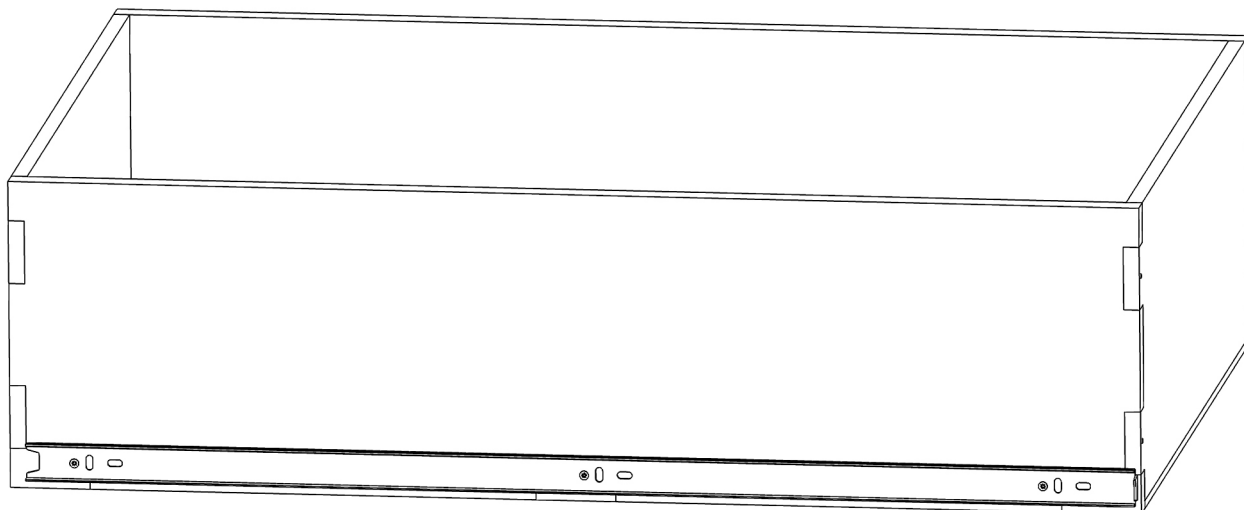
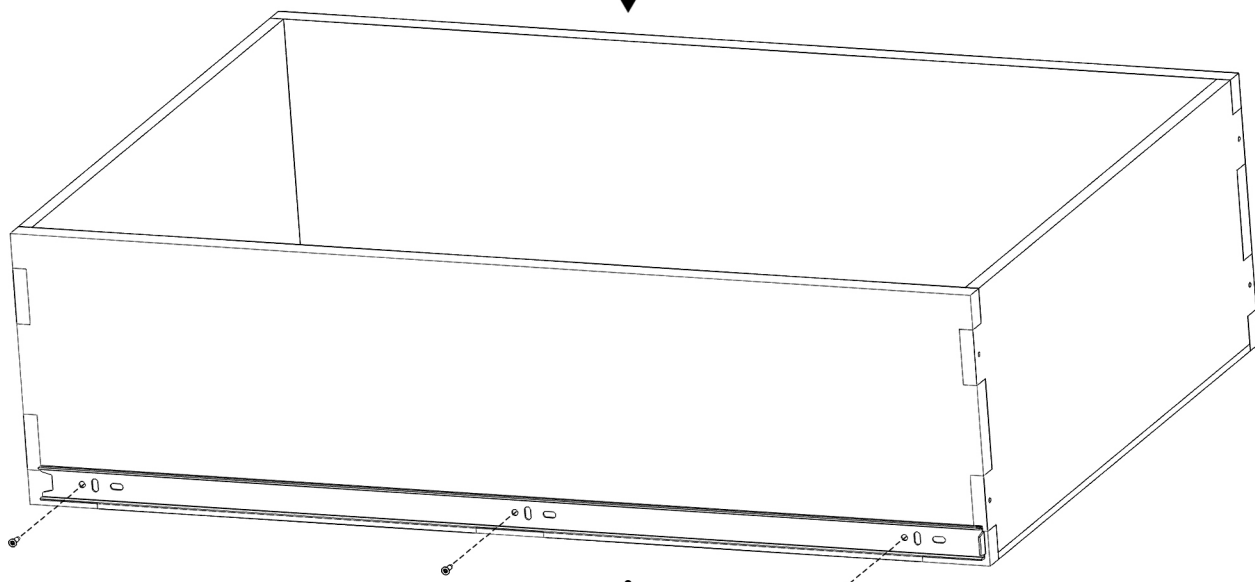
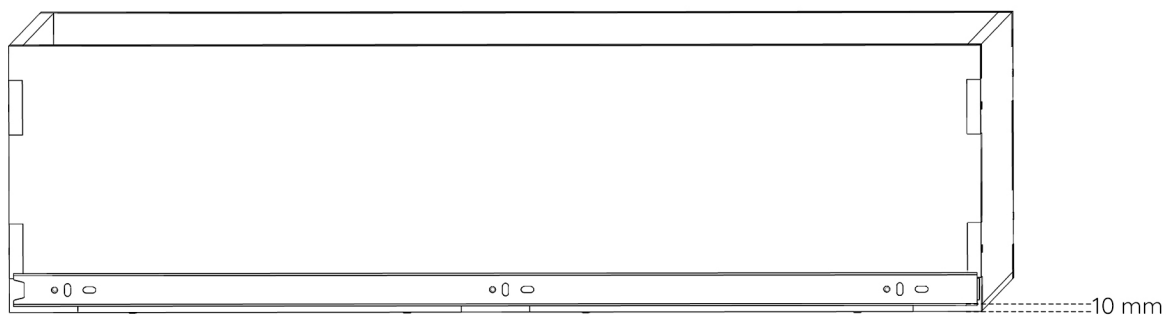



1 Installing the slide supports on the bed

Two possibilities: depending on whether you have positioned the 60 cm or 120 cm part of your bed at the back of the van.

1.1 60 cm section at the rear of the van

Screw the 70 cm slides into the pilot holes of the bed frame with 15 mm screws.

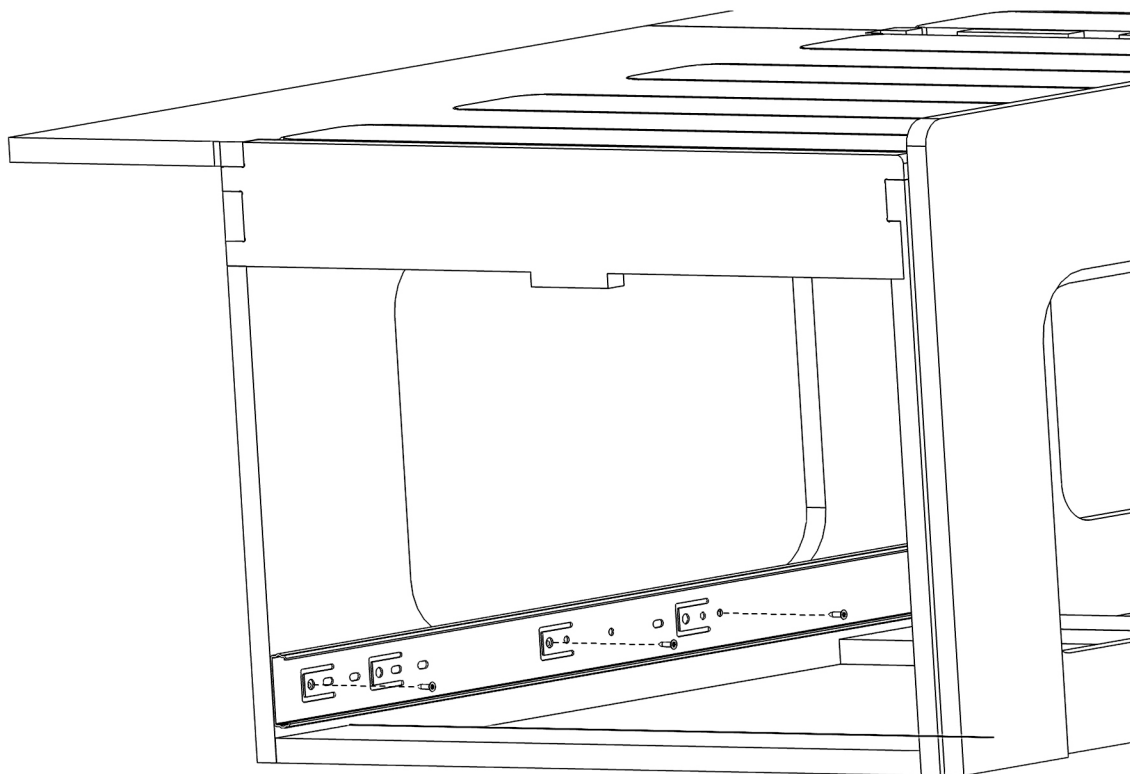

1.2 120 cm section at the rear of the van

Place the slides parallel to the floor as below at a height of 42 mm (axis of the slide along the length) and screw each slide with 15 mm screws.

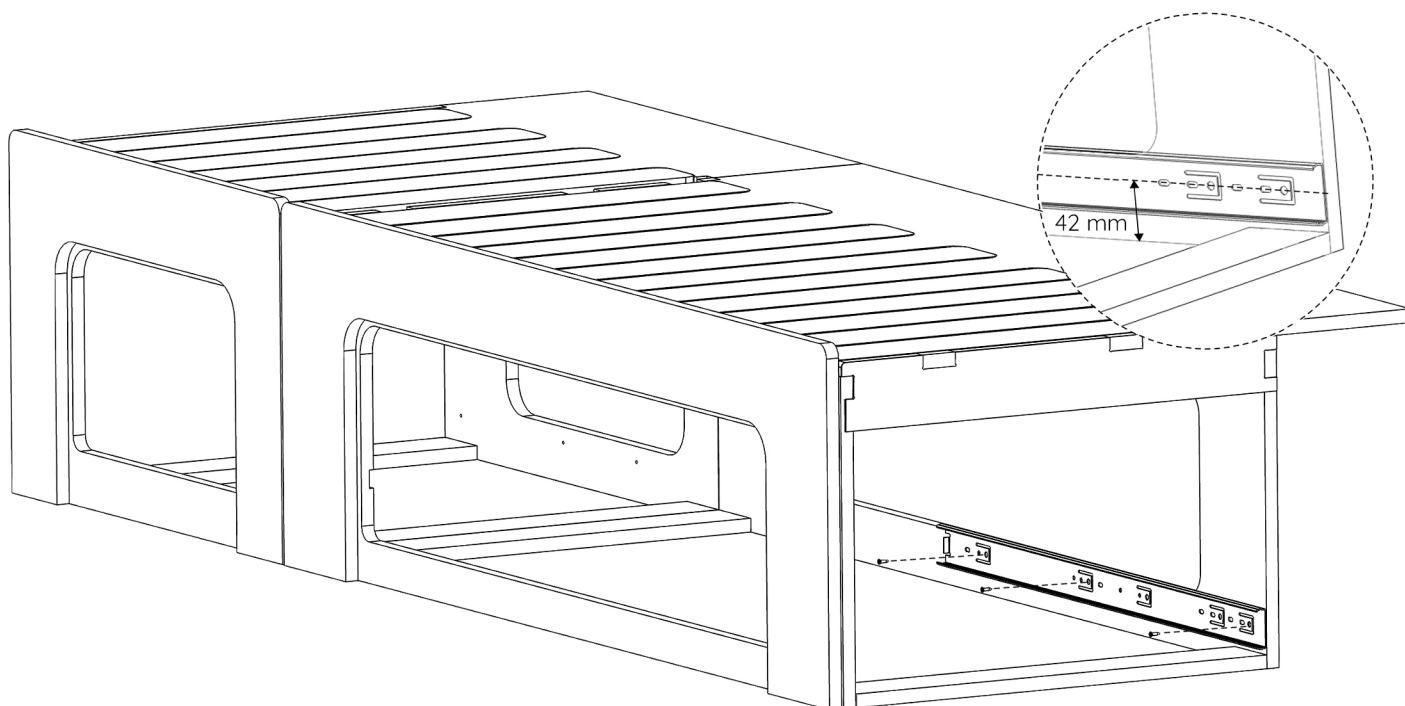

SUPPORT FOR SLIDES, PUSH LOCK & FACADE

2 Facade installation

2.1 Pre-screw 2 large diameter 25 mm screws into part **E**.

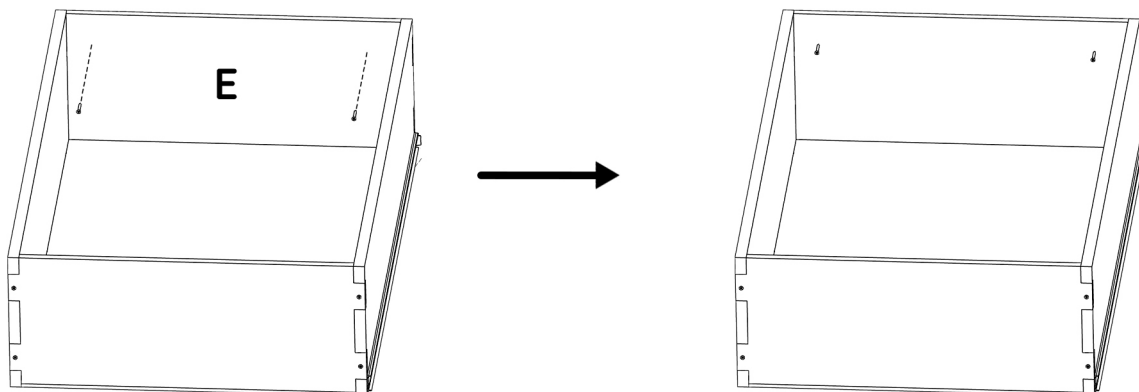

2.2 Place the drawer in the bed slides.

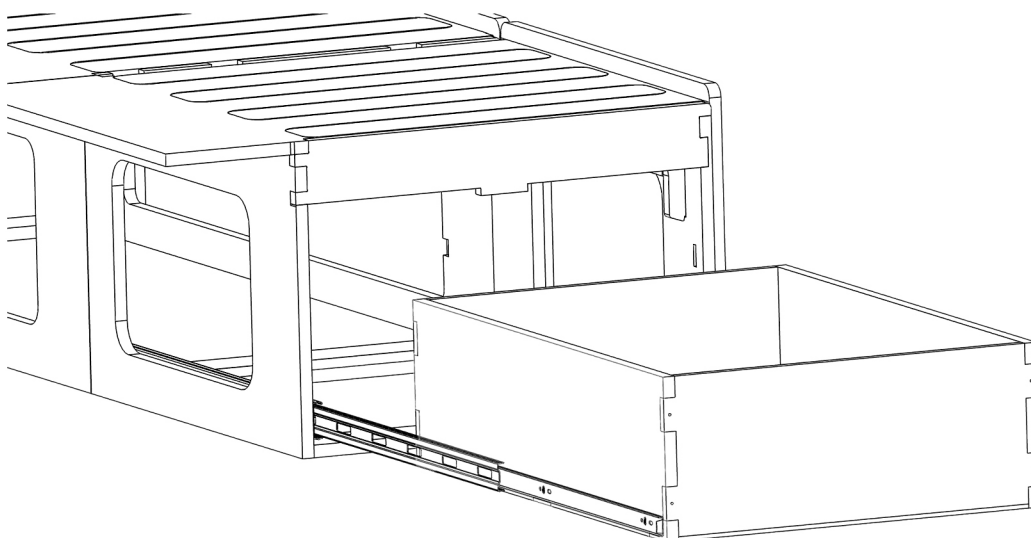

2.3 Position and center the bed front in its frame.
To facilitate access to the drawer inside, remove the movable part of the bed while holding the front in position. **Lock the front in place by tightening the two screws already in place on part E.**

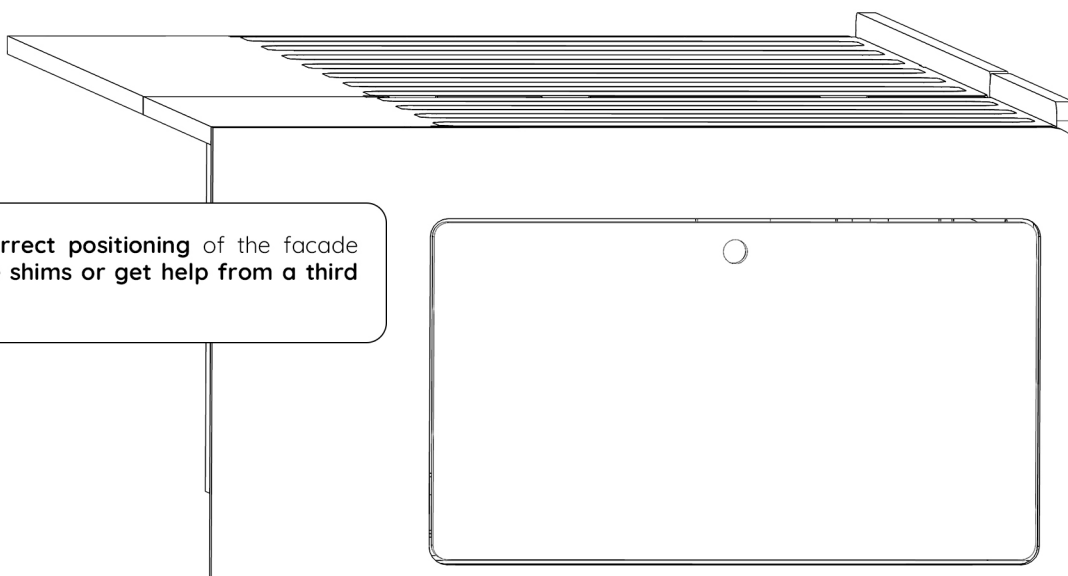

i To maintain the correct positioning of the facade before screwing, use shims or get help from a third party.

SUPPORT FOR SLIDES, PUSH LOCK & FACADE

- 2.4** Finish screwing the front as shown below using 4 other 25 mm large diameter screws from the inside of the drawer.

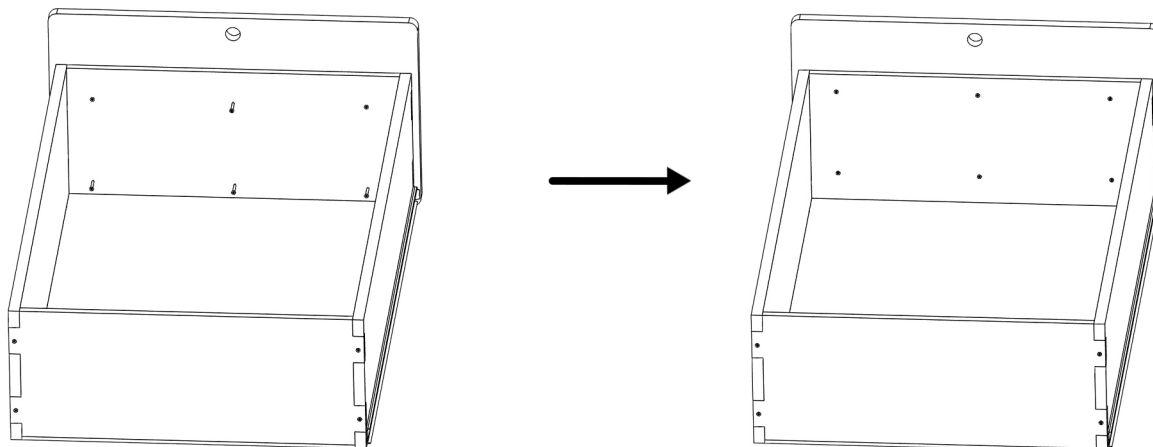

3 Push lock installation

- 3.1** Force the push lock rosette onto the front of the drawer front.

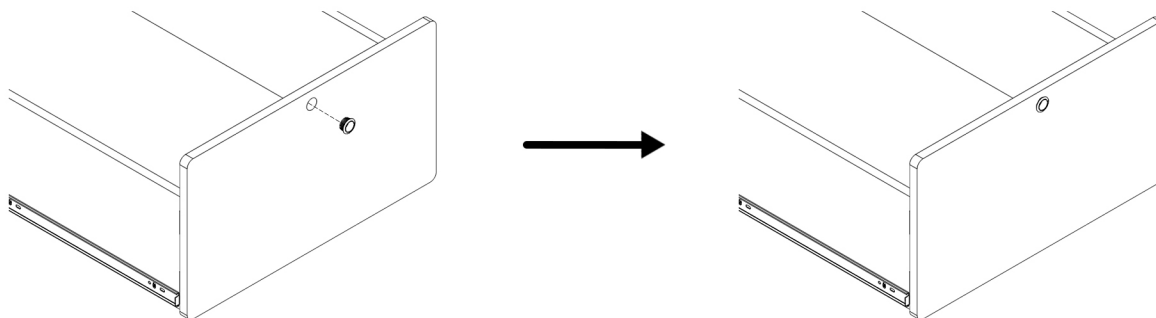

- 3.2** Screw the button onto the push lock.

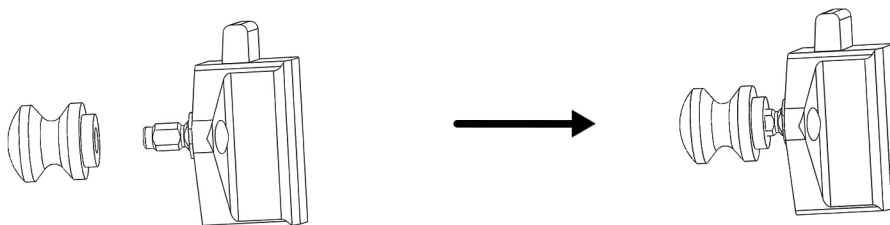

- 3.3** Screw the push lock into part C with two 12 mm screws. Make sure it is aligned with the bottom of the part.

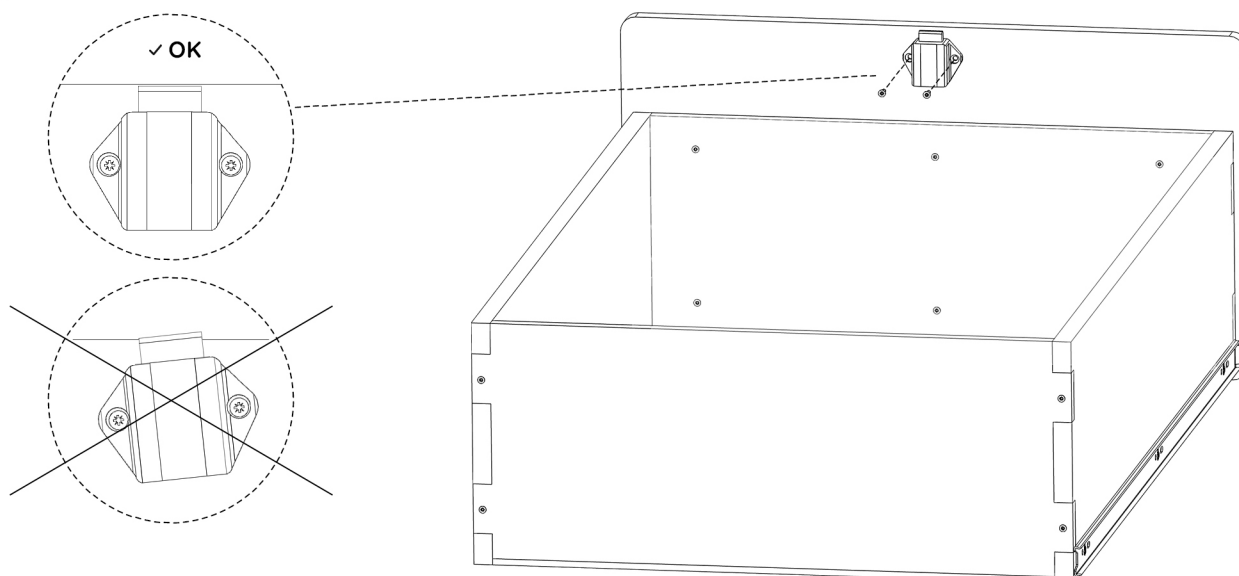

SUPPORT FOR SLIDES, PUSH LOCK & FACADE

4 Installing and Adjusting the Drawer

- 4.1** Slide the drawer into the runners until you hear the locking “click”.

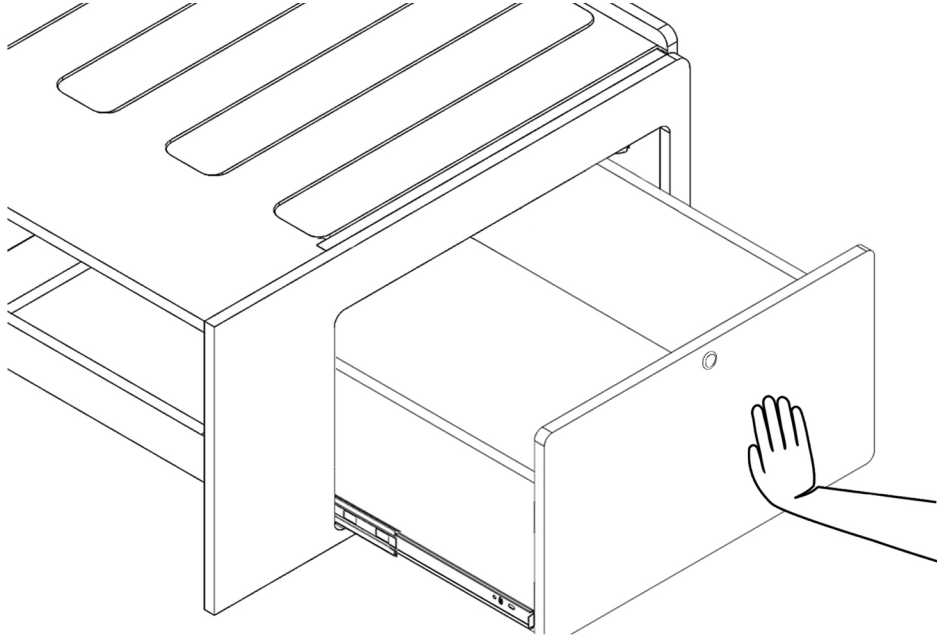

- 4.2** To adjust the drawer height, loosen the drawer slide mounting screws, move the drawer up or down, and retighten the 15 mm screws.

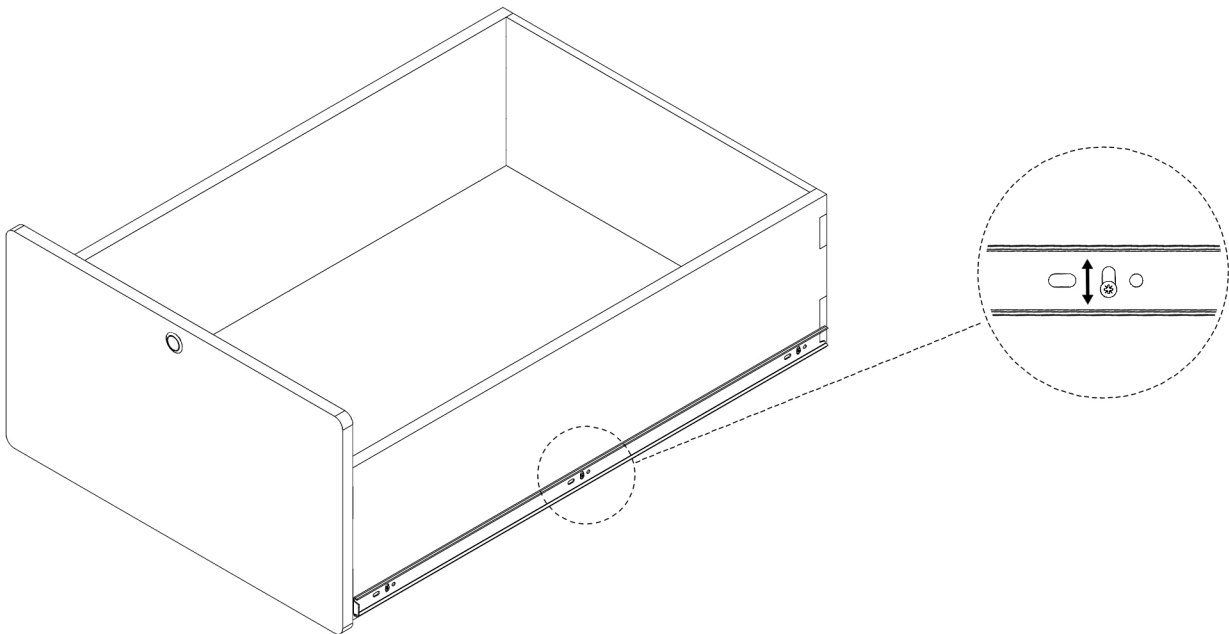

HAPPY ASSEMBLY!

If you have any comments regarding the assembly,
you can let us know by email:
sav@simplevans.eu

**ALL
TUTORIALS
HERE**



SHARE YOUR EPIC VAN BUILD JOURNEY WITH US AND THE COMMUNITY!

#SimpleVansLife

**Snap some pics or record a video of your awesome furniture
installed and ready for adventure.**

We'll feature the best content on our social media channels,
and the most inspiring builds will win incredible prizes!

