

# Assembly guide

## D4 Unit



**WELCOME ABOARD!**

Let's assemble Your dream furniture and get you on the road.

**LET'S GO !**

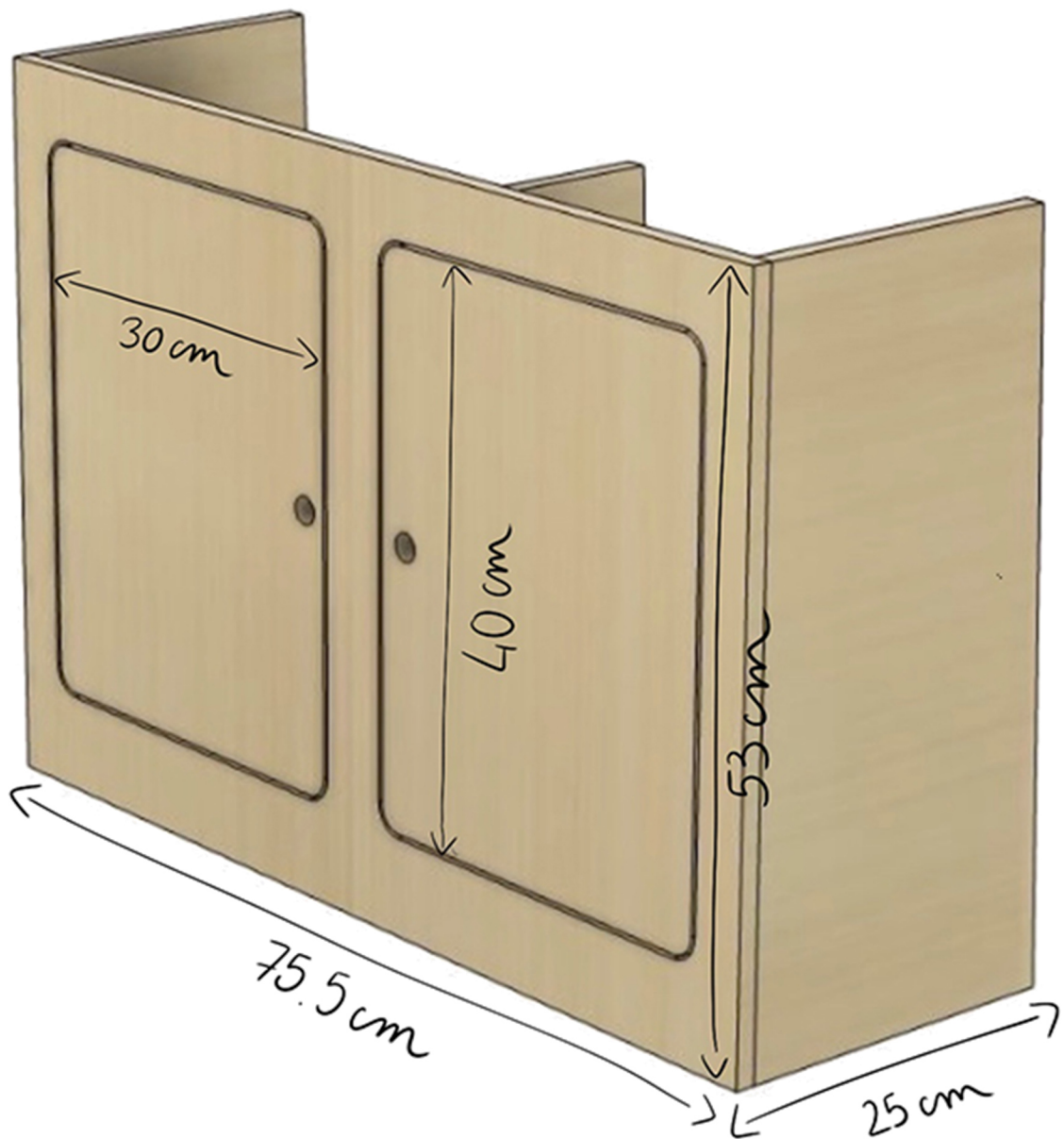

## **SHOW OFF YOUR SKILLS & INSPIRE THE VANLIFE COMMUNITY!**

Share your build on Facebook, Instagram ou TikTok.

Use #SimpleVansLife :

**Best content wins awesome prizes.**



# Materials required for assembly

- Masking tape
- Square (optional)
- PZ1 & PZ2 screwdriver
- Wood glue (slow-drying recommended)
- Damp cloth (or paper towel)
- Putty knife or ruler (for positioning hinges)
- Pencil (for marking hinge placement)

## Package contents :



Screw PZ1 12 mm X **24**



Screw PZ2 15 mm X **56**

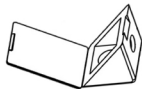

Beige bracket  
X **16**

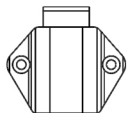

Mini lock  
X **2**



Push button  
X **2**

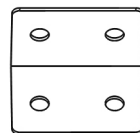

Metal bracket  
X **4**

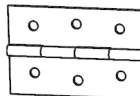

Hinge  
X **4**



5mm wooden latch  
X **2**

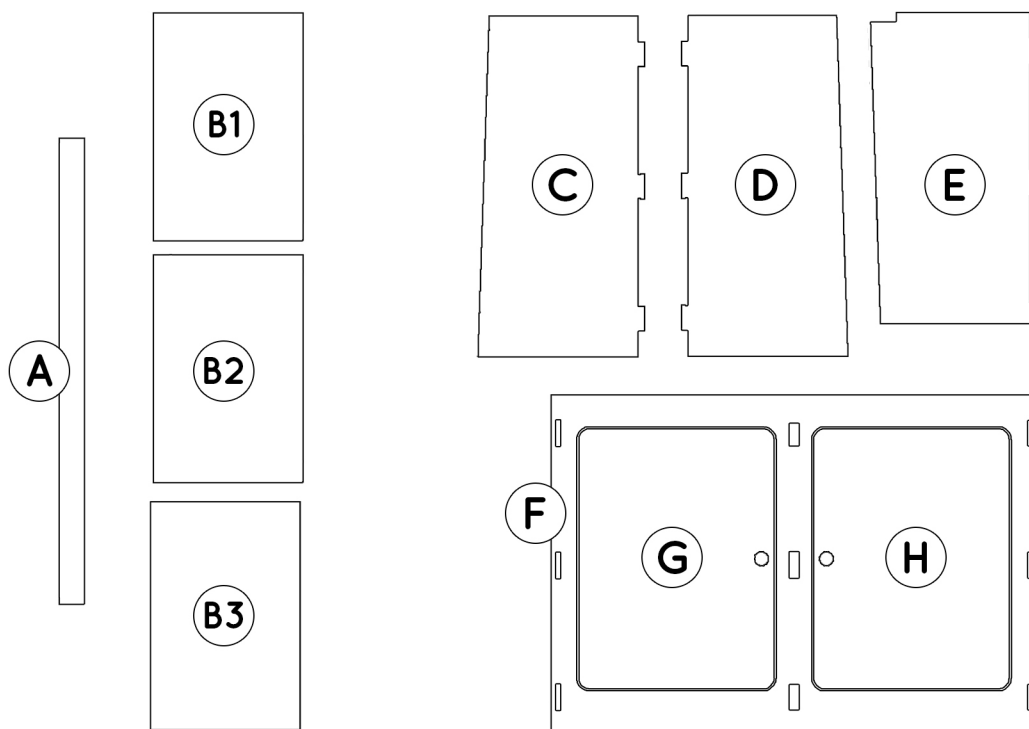

## Read before assembling the furniture

- Check for chips in the grooves
- Check that the parts are free of defects before gluing / or make a dry fitting
- Read the entire instructions carefully before final assembly with glue
- Wipe off excess glue with a damp cloth immediately after gluing each piece
- Make any cuts (if necessary) before gluing the furniture
- Protect the surrounding areas of the gluing areas with masking tape to reduce cleaning

If you have a problem with a part or accessory, please contact us by email: [sav@simplevans.eu](mailto:sav@simplevans.eu)



Apply a sufficient amount of glue to the contact surfaces and grooves.

The glue should **slightly protrude from the grooves when assembled**.

**Wipe off excess glue** with a damp cloth after assembly.

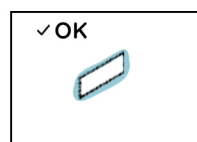
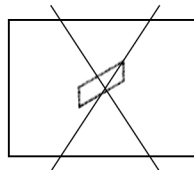
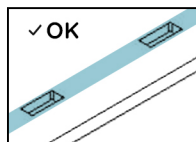
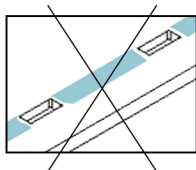

glue that slightly protrudes  
after assembly

1

Apply glue to the notches and junction and assemble part **C** to part **F**.

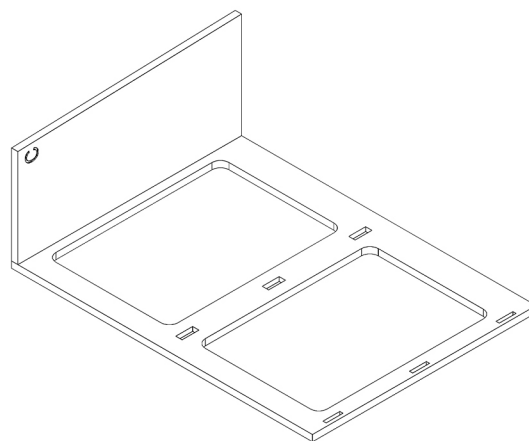
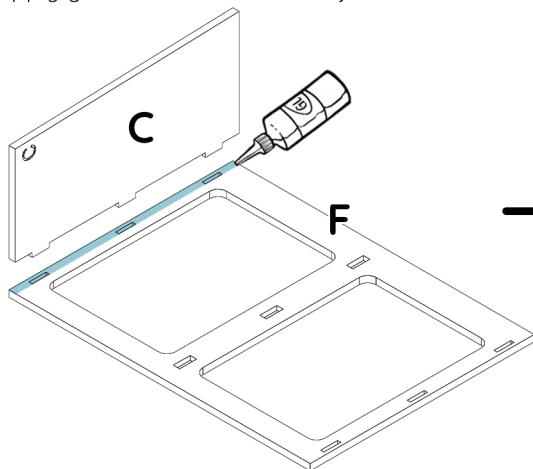

2

Apply glue to the notches and junction and assemble part **E** to part **F**.

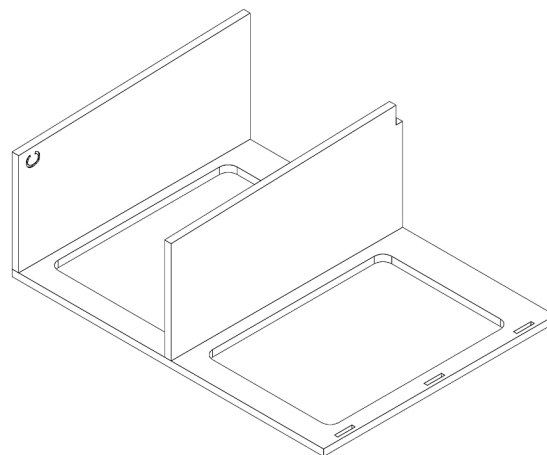
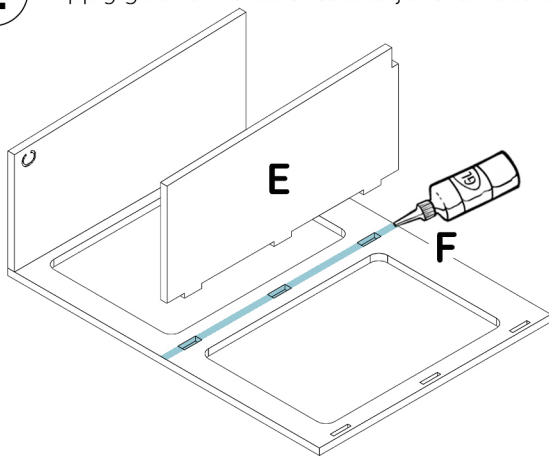

3

Apply glue to the notches and junction and assemble part **D** onto part **F**.

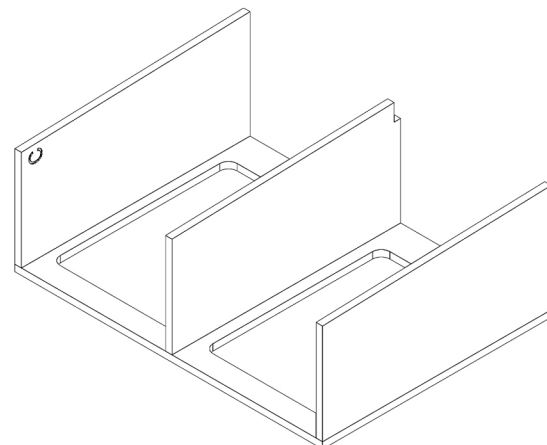
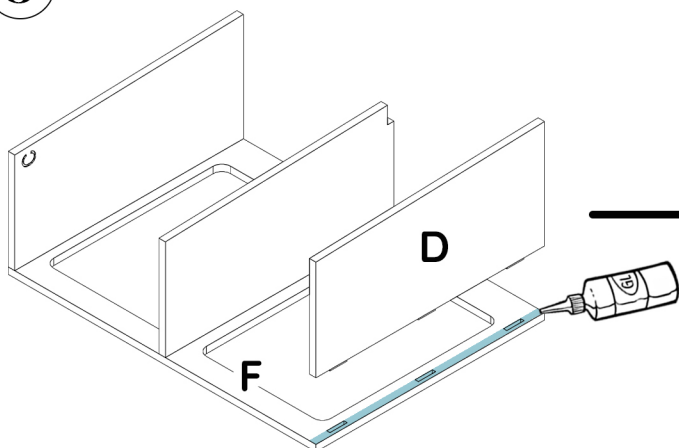



## FURNITURE ASSEMBLY

- 4** Apply glue to the notches and junction and assemble part **A** with the rest of the furniture.

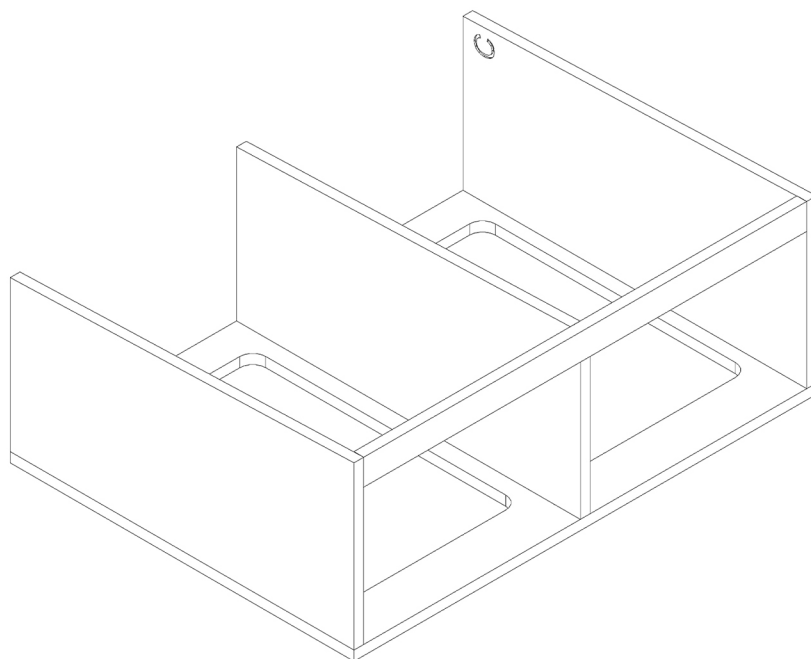
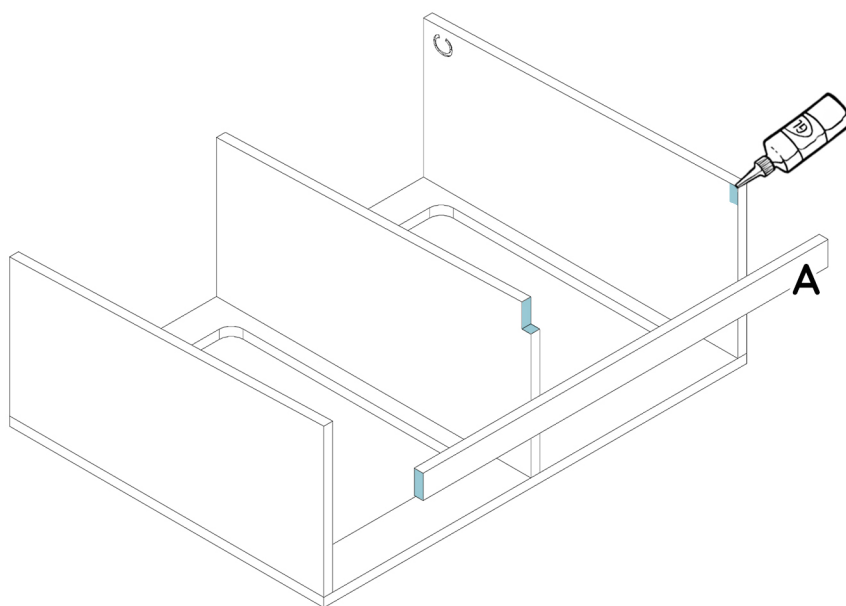

Use masking tape to hold part **A** in position while it dries.



## Door assembly philosophy

- 2 hinges per door
- Position the hinges along the longest length opposite the push-lock button location
- Before screwing the push-lock and hinges, make sure to screw them on the correct side of the front, respecting the wood grain.

## 1 Pushlock assembly

**1.1** Force-insert the push lock rosette on the visible side of doors **G & H**.

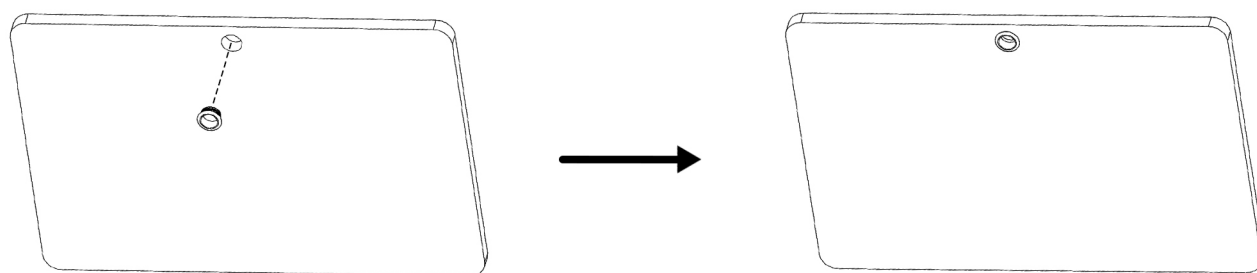

**1.2** Screw the button onto the push lock..

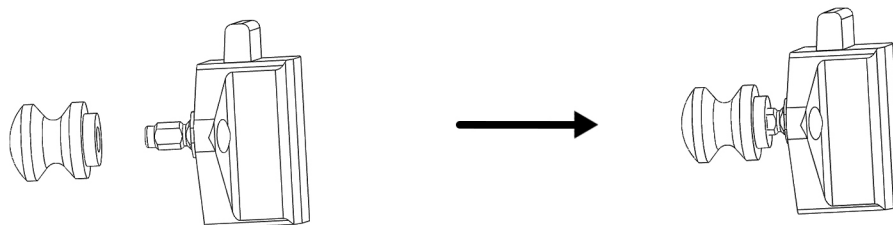

**1.3** Screw the push lock onto the door with two 12mm screws. **Make sure it is aligned with the side of the door.**

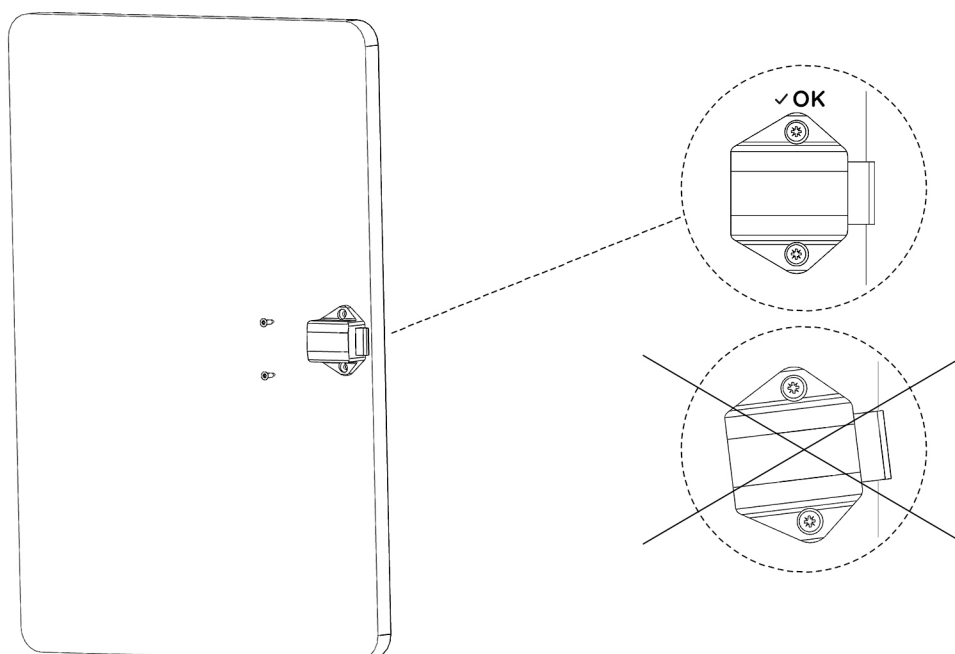

# ASSEMBLY OF DOORS, HINGES AND PUSHLOCKS

## 2 Hinges assembly

- 2.1** Position the hinges 5 cm from the edge of the door and fold the hinge onto the FRONT of the door then screw them in using 12 mm screws.

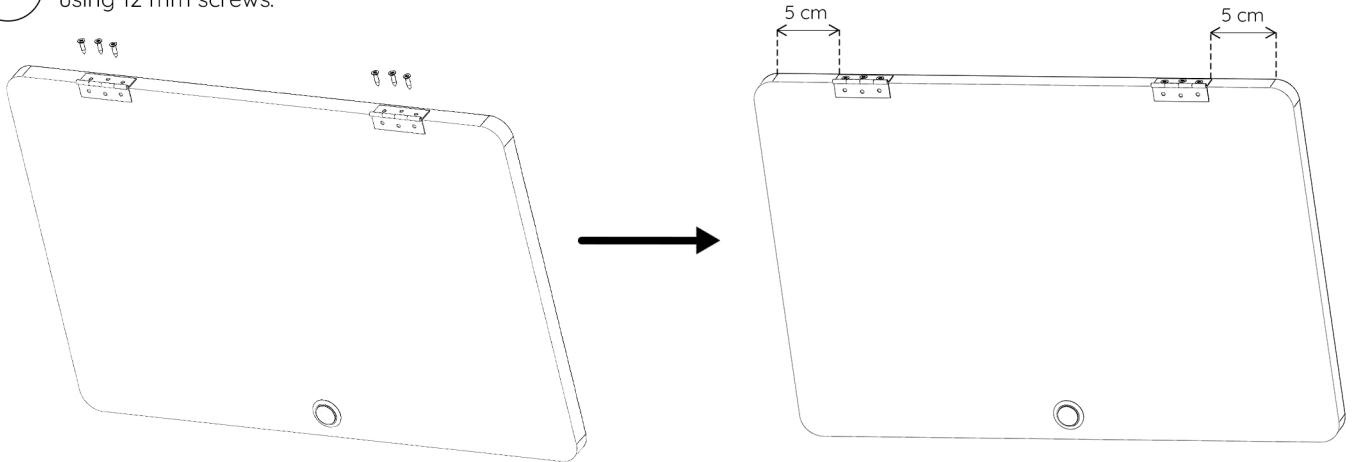

- 2.2** Position the door (**door G** in this example) in its frame and center it, then fold the hinge onto the front of the furniture and make a slight mark using a pencil or tape.

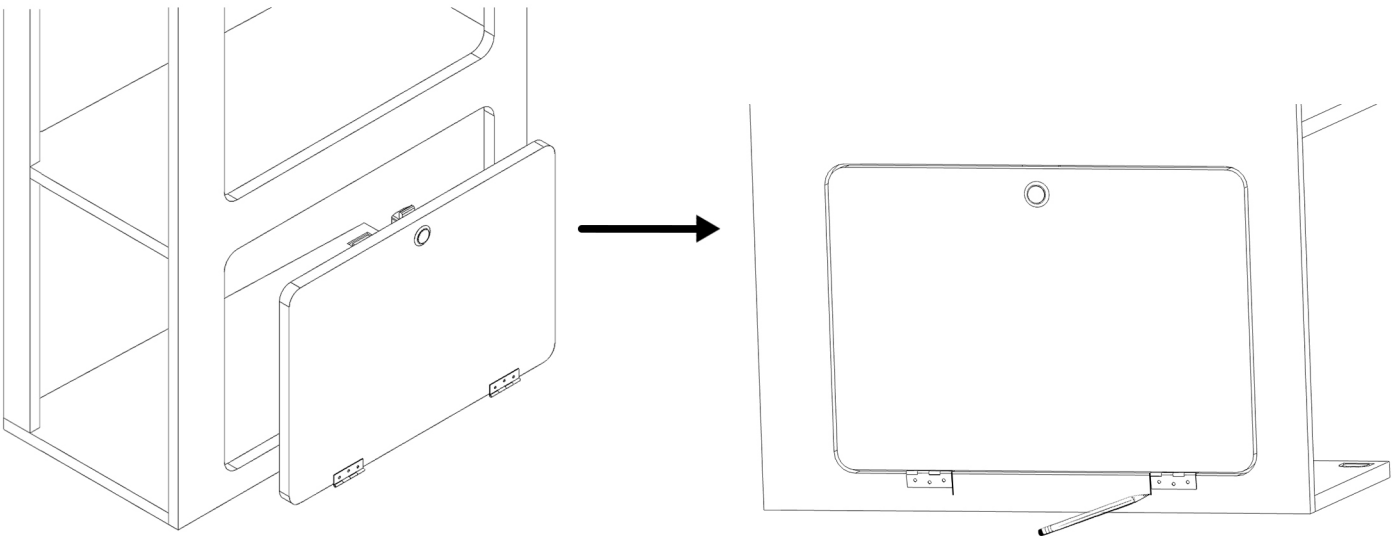

- 2.3** **Align one hinge** with the front of the cabinet and fold it down over the front of the cabinet to match the previously marked hole. **Then screw in a 12mm screw** (hole in the middle of the hinge). Unscrew the hinge and repeat this process to mark the hole for the second hinge, then unscrew the hinge.

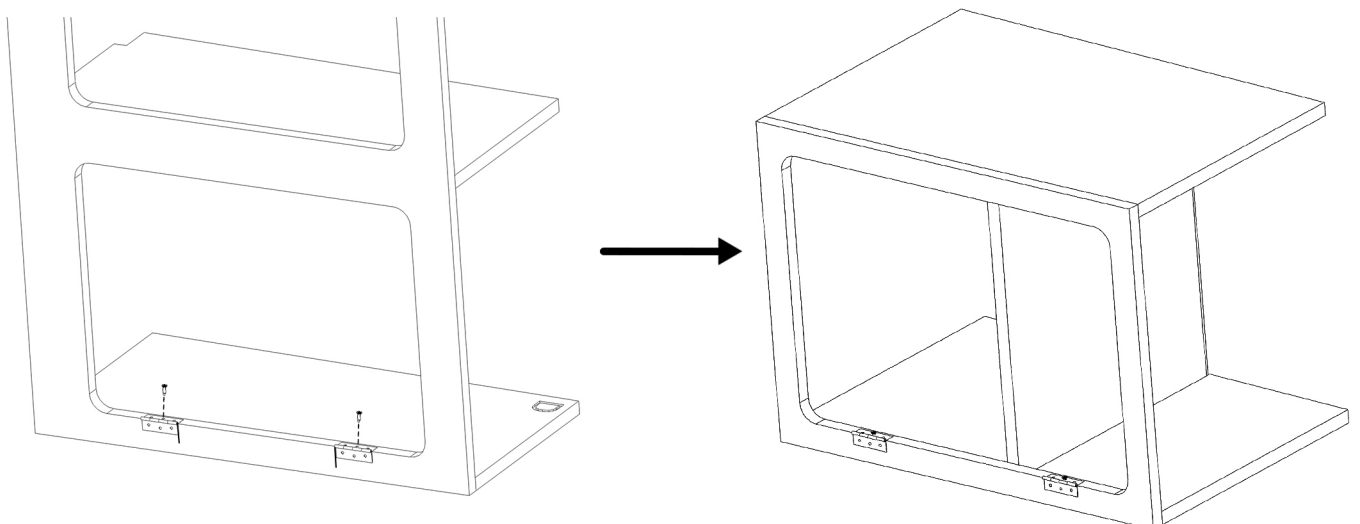

## ASSEMBLY OF DOORS, HINGES AND PUSHLOCKS

- 2.5** With the door fitted with its screwed hinges, screw the hinges onto the furniture using the 12 mm screws, using the reference holes made in the previous step.

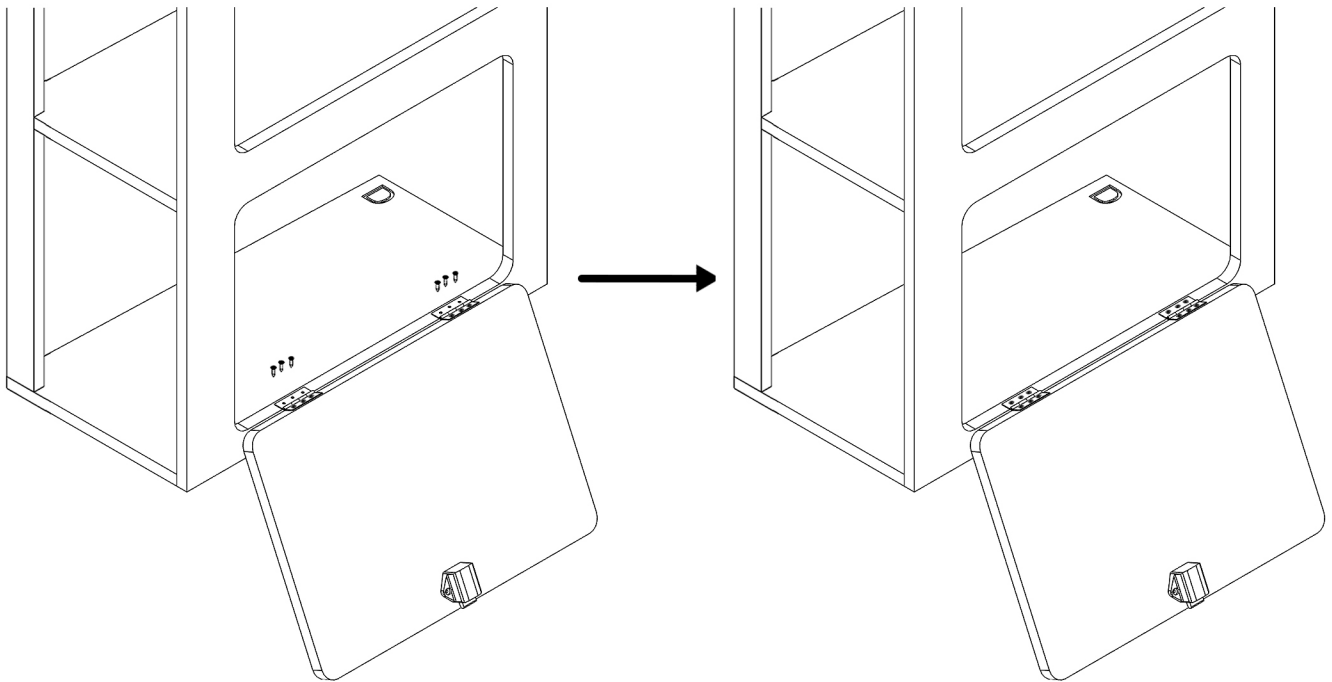

### **3** Mounting the stop

Close and lock the door then screw the 5mm latch inside the cabinet as below with 12mm screws.

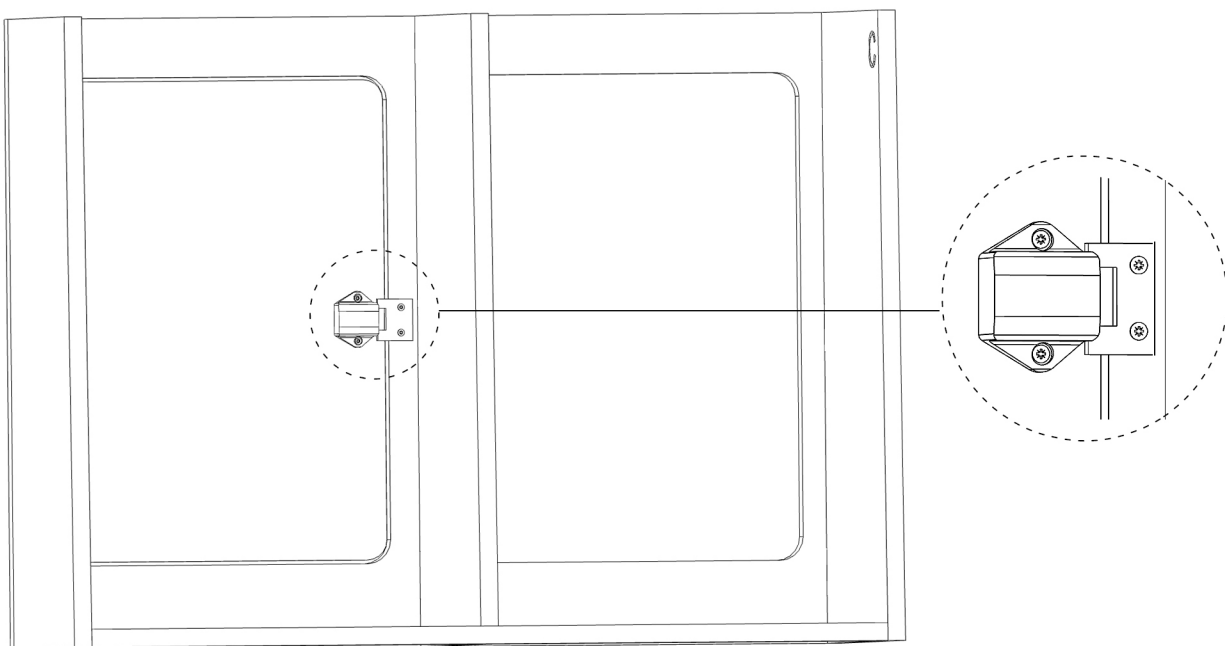

Proceed in exactly the same way for the assembly of the opposite door H.

# ASSEMBLY OF SHELVES



Estimated time: 15 min

- 1** Place the shelves at the desired height and fix them using 4 beige corner brackets per shelf (1 at each corner) and two 15 mm screws per bracket.

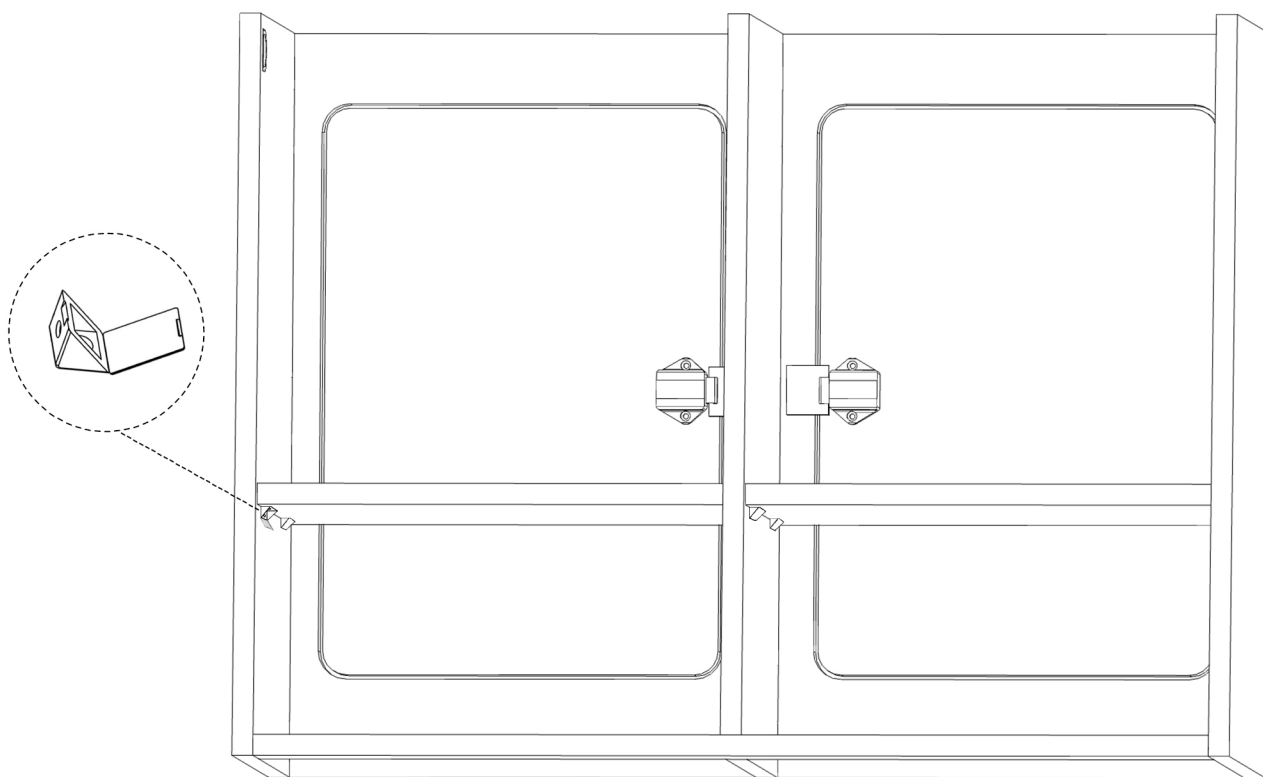

- 2** Then fix the D4 unit to the unit on which it is placed and/or to the wall of your van using the remaining beige brackets and 15 mm screws.



# HAPPY ASSEMBLY!

If you have any comments regarding the assembly,  
you can let us know by email:  
**sav@simplevans.eu**

**ALL  
TUTORIALS →  
HERE**



## SHARE YOUR EPIC VAN BUILD JOURNEY WITH US AND THE COMMUNITY!

#SimpleVansLife

**Snap some pics or record a video of your awesome furniture  
installed and ready for adventure.**

We'll feature the best content on our social media channels,  
and the most inspiring builds will win incredible prizes!

