

Assembly guide

AP Unit



WELCOME ABOARD!

Let's assemble Your dream furniture and get you on the road.

LET'S GO !

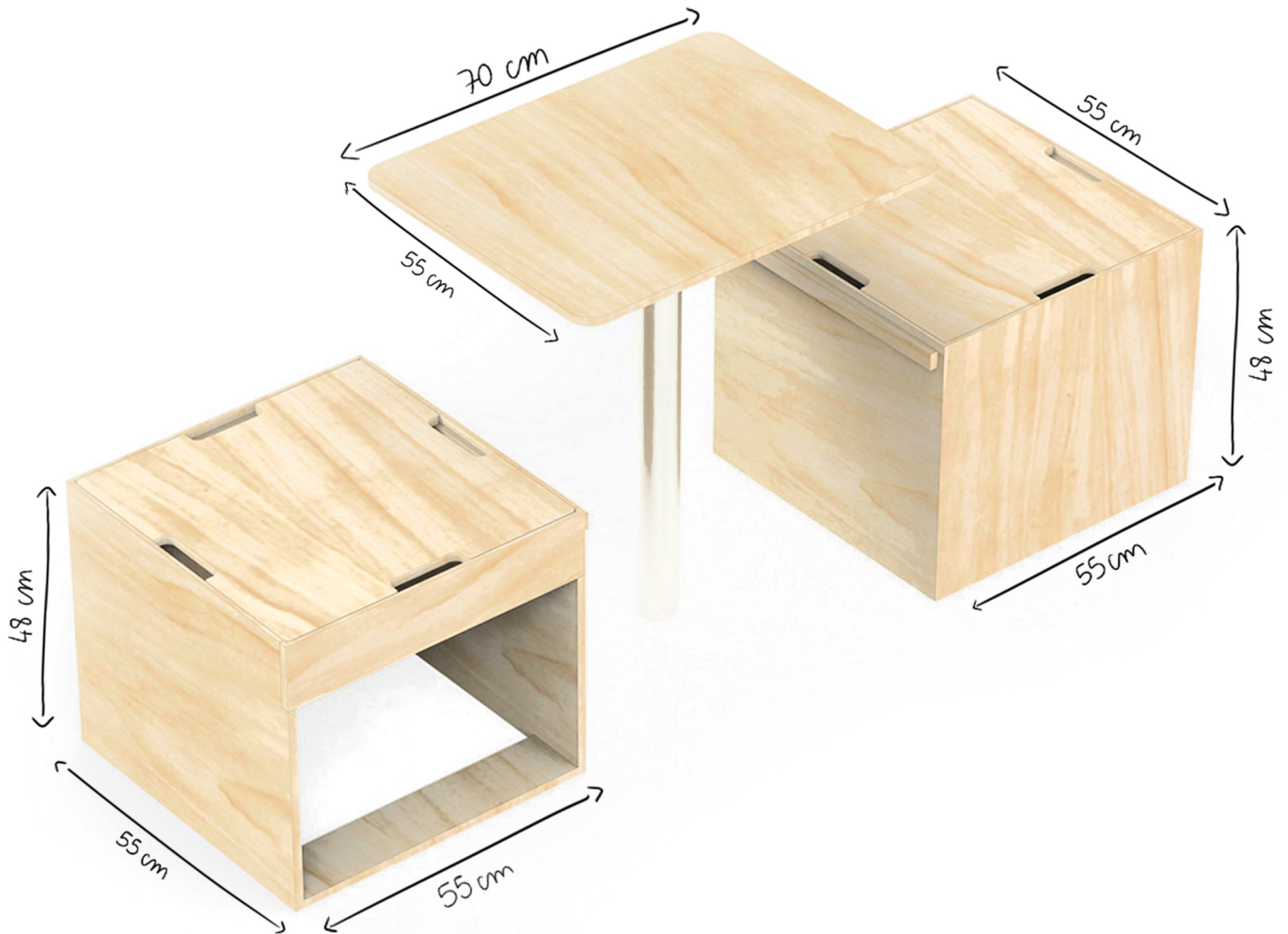

SHOW OFF YOUR SKILLS & INSPIRE THE VANLIFE COMMUNITY!

Share your build on Facebook, Instagram ou TikTok.

Use #SimpleVansLife :

Best content wins awesome prizes.



Materials required for assembly

- Masking tape
- Square (optional)
- PZ1 & PZ2 screwdriver
- Wood glue (slow-drying recommended)
- Damp cloth (or paper towel)

Package contents :

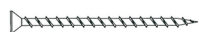
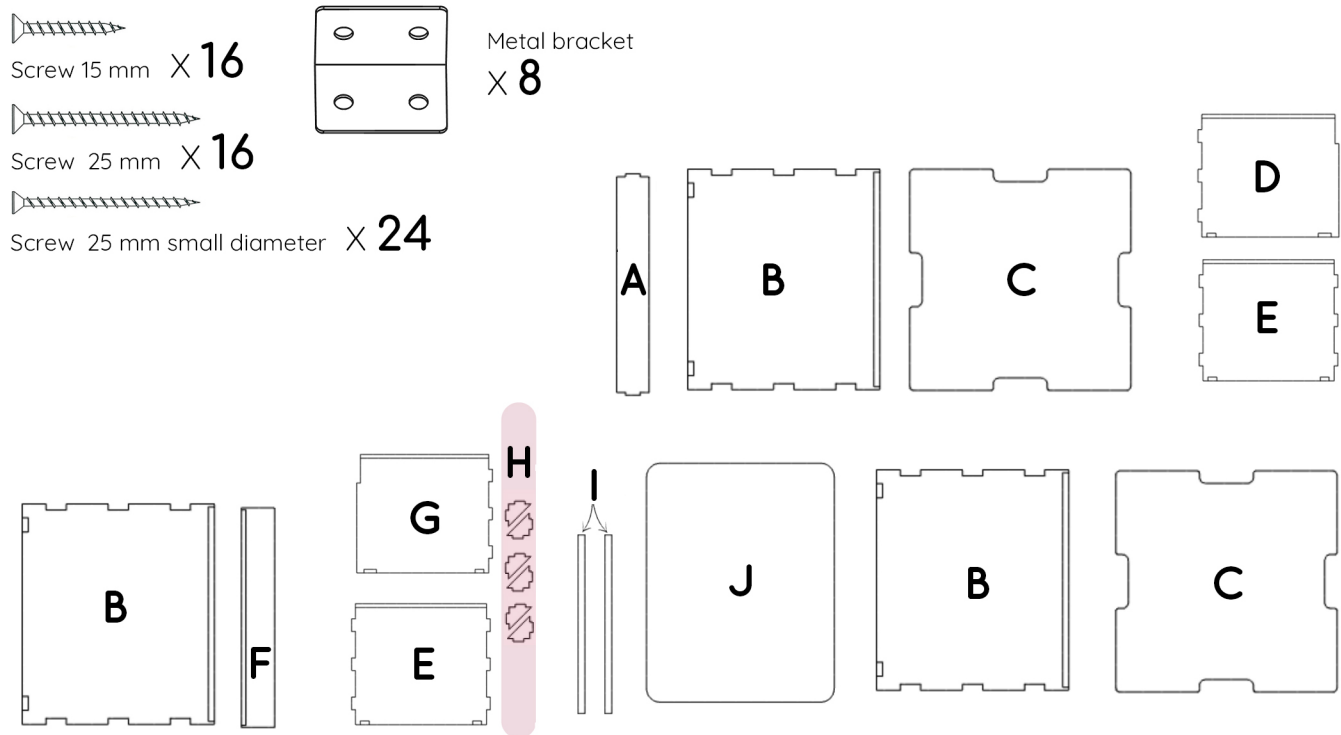

ASSEMBLY TIP

We provide **25 mm thin screws** that you can add to the hidden sides of the furniture to simplify and strengthen assembly.

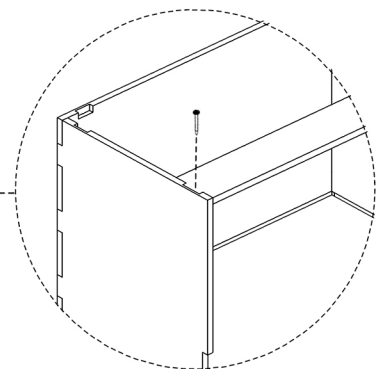

Read before assembling the furniture

- Check for chips in the grooves
- Check that the parts are free of defects before gluing / or make a dry fitting
- Read the entire instructions carefully before final assembly with glue
- Wipe off excess glue with a damp cloth immediately after gluing each piece
- Make any cuts (if necessary) before gluing the furniture
- Protect the surrounding areas of the gluing areas with masking tape to reduce cleaning

If you have a problem with a part or accessory, please contact us by email: sav@simplevans.eu



Apply a sufficient amount of glue to the contact surfaces and grooves.

The glue should **slightly protrude from the grooves when assembled**.

Wipe off excess glue with a damp cloth after assembly.

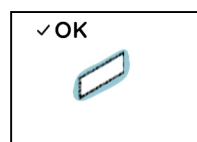
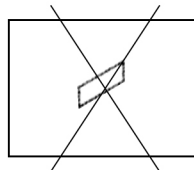
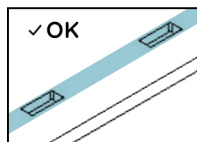
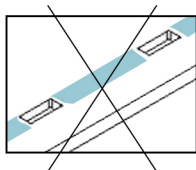

glue that comes out slightly after assembly

1

Apply glue to the notches and joints then assemble parts **B** and **E**.

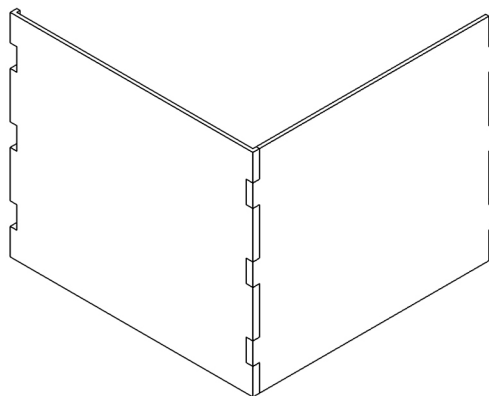
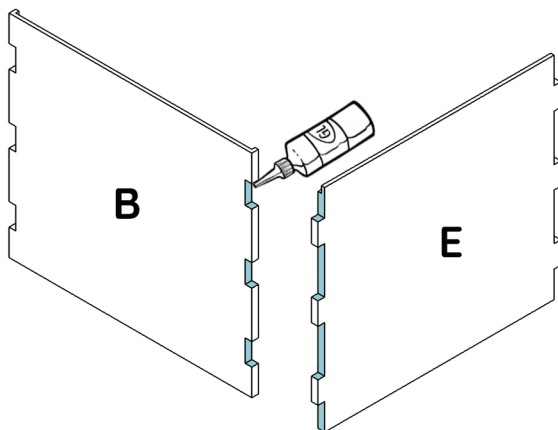

2

Apply glue to the notches and joints then assemble parts **B** and **E**.

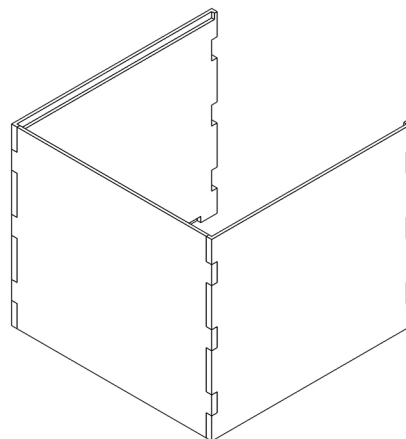
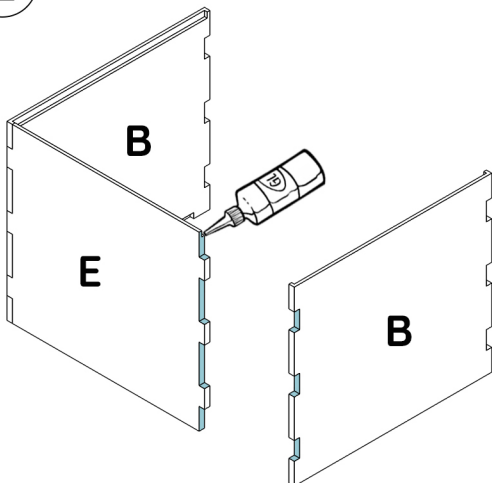

3

Apply glue to the notches and joints then assemble part **E** with the rest of the furniture.

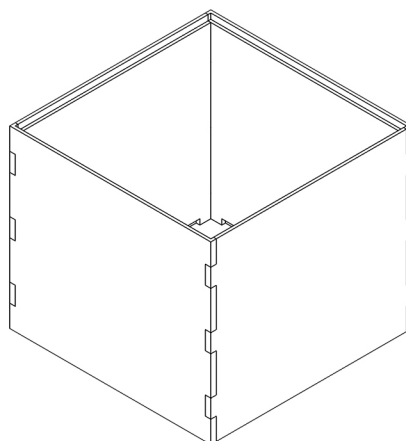
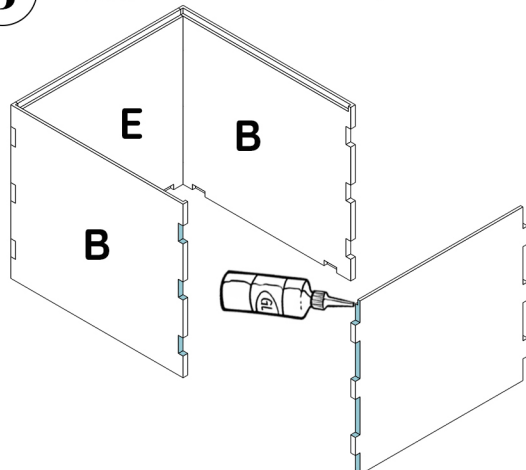

FURNITURE ASSEMBLY

- 4 Apply glue to the notches and joints and assemble the four **H** angles with the rest of the furniture.

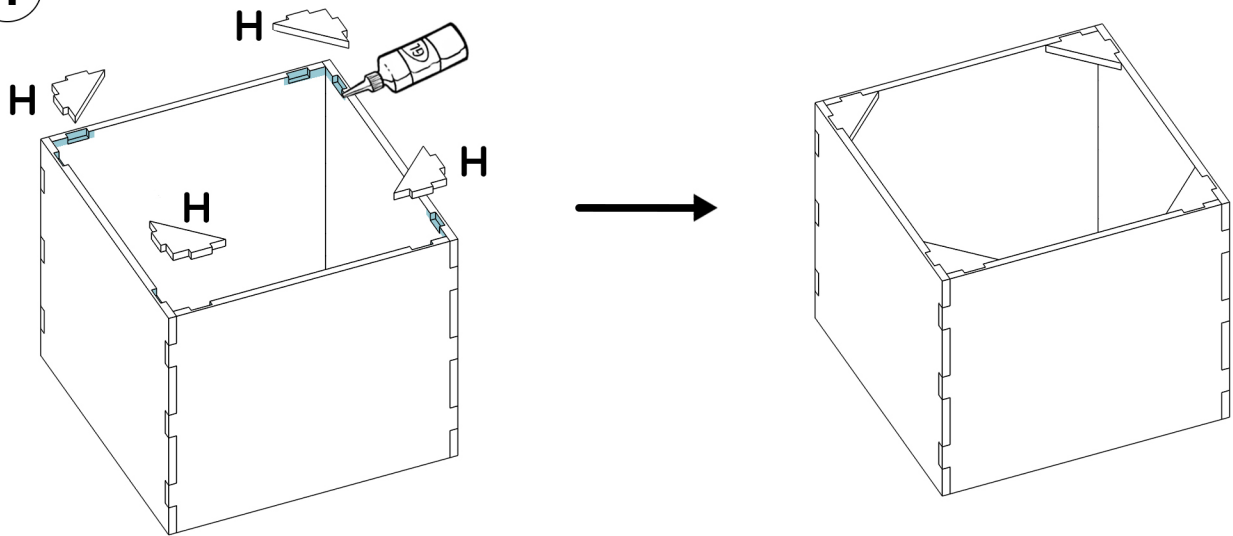

- 5 Apply glue and assemble part **I** with the rest of the furniture, then screw part **I** from the inside of the furniture using 3 thin 25 mm screws.

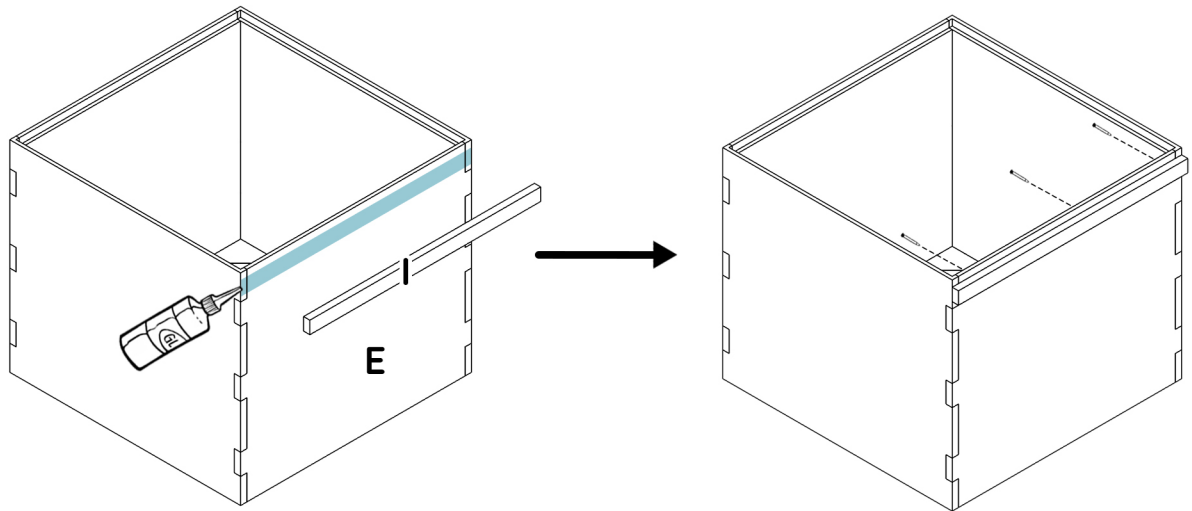

- 6 Apply glue to the notches and joints and assemble parts **B** and **G**.

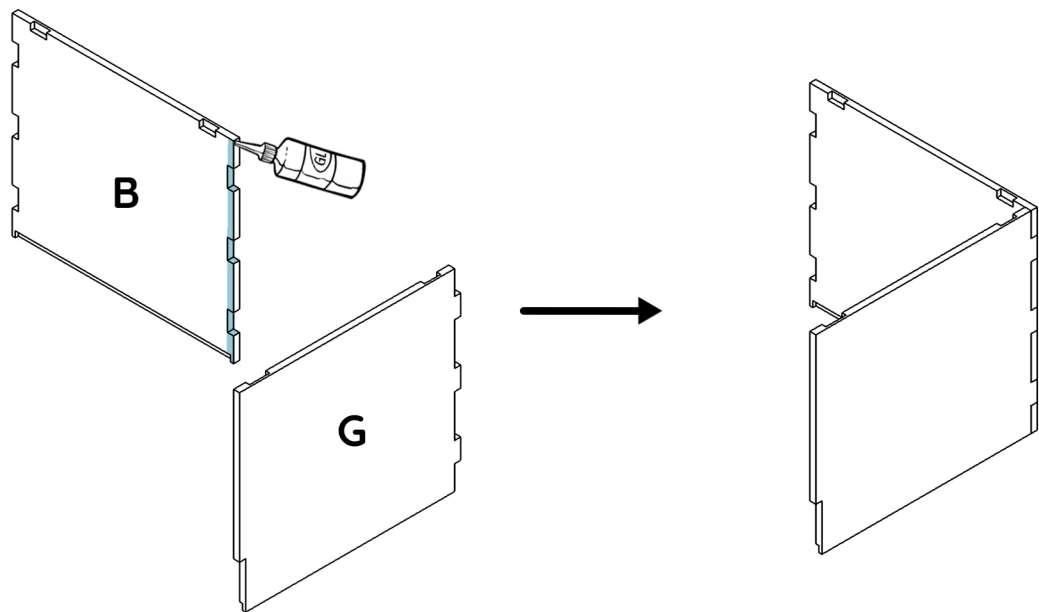

FURNITURE ASSEMBLY

- 7 Apply glue to the notches and joints then assemble parts **B** and **D**.

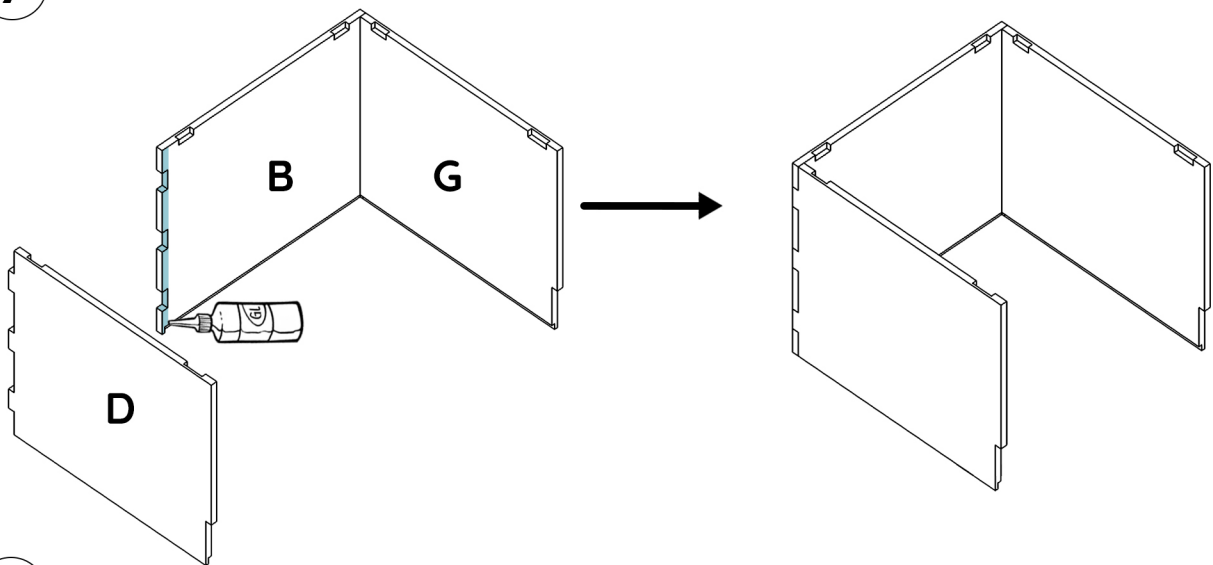

- 8 Apply glue to the notches and joints, then assemble part **A** with the rest of the furniture.

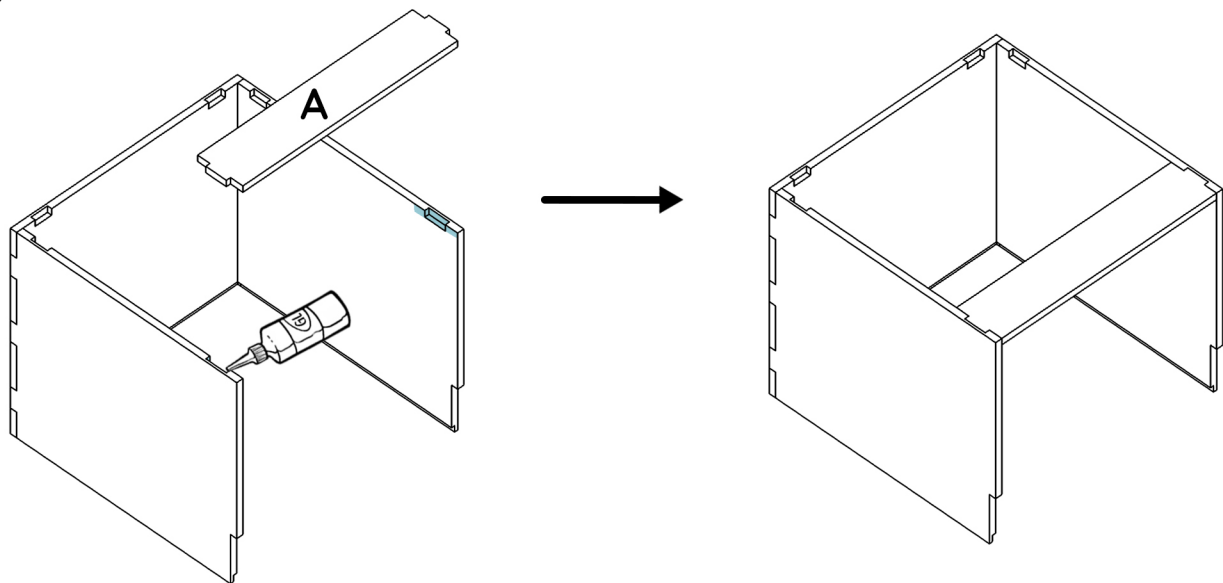

- 9 Apply glue to the notches and joints and assemble the two **H** angles with the rest of the furniture.

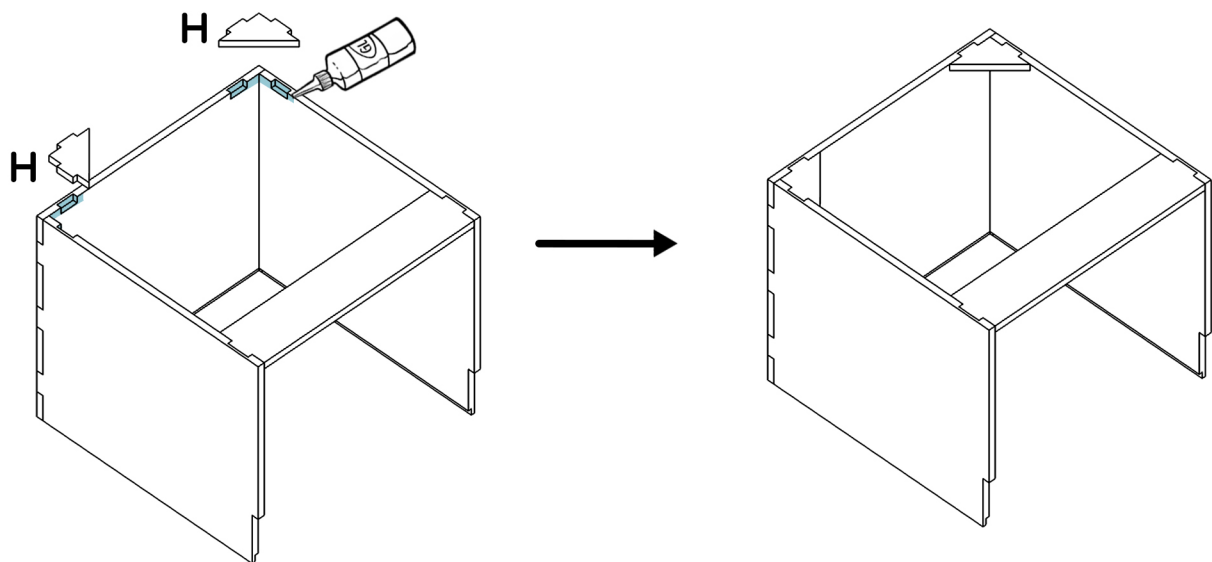

FURNITURE ASSEMBLY

- 10** Apply glue to the notches and joints and assemble part **F** with the rest of the furniture.

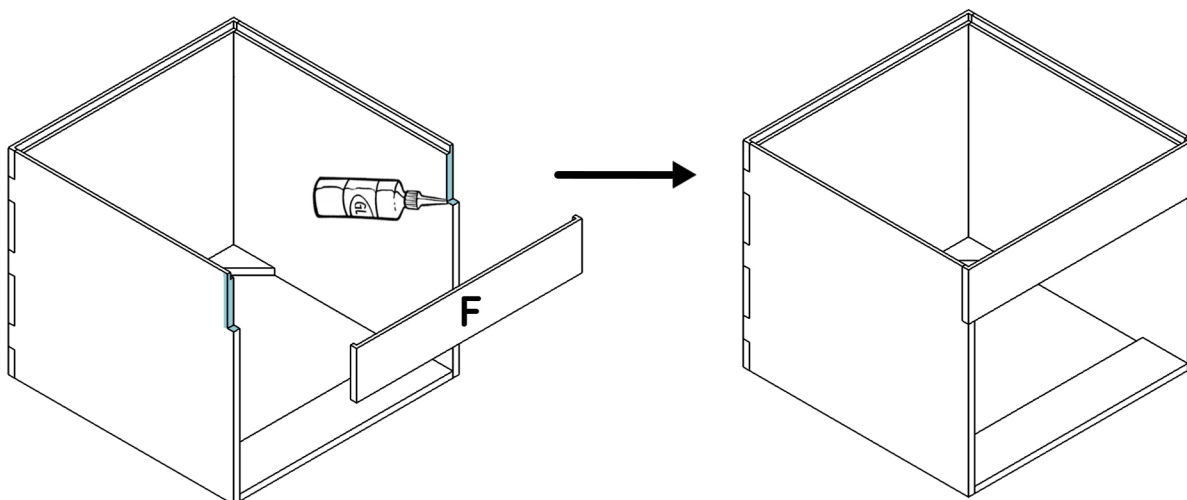

- 11** Apply glue and assemble part **I** with the rest of the furniture, then screw part **I** from the inside of the furniture using 3 thin 25 mm screws.

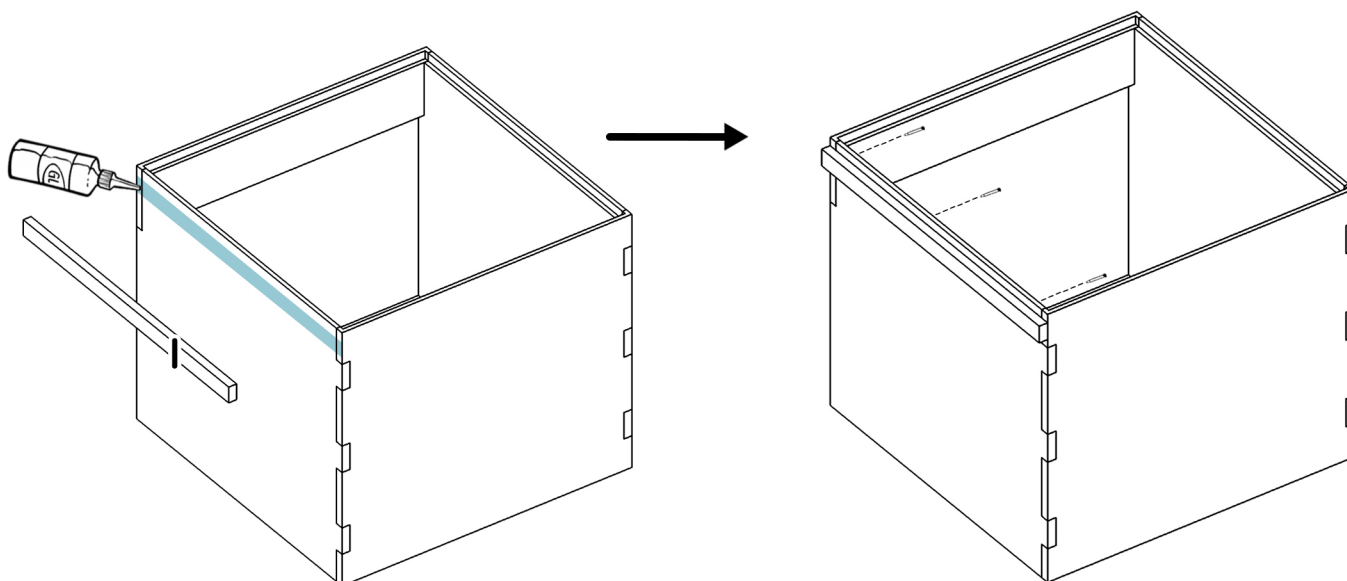

HAPPY ASSEMBLY!

If you have any comments regarding the assembly,
you can let us know by email:
sav@simplevans.eu

**ALL
TUTORIALS
HERE**



SHARE YOUR EPIC VAN BUILD JOURNEY WITH US AND THE COMMUNITY!

#SimpleVansLife

**Snap some pics or record a video of your awesome furniture
installed and ready for adventure.**

We'll feature the best content on our social media channels,
and the most inspiring builds will win incredible prizes!

